

45 系列铝型材 - 连接件

锚式连接销

■ 锚式连接销



库存

材质	表面处理
碳钢	镀锌

● 具有连接和锁紧功能，隐蔽性好，保证连接处没有缝隙，连接时只占用一个 T 型槽，方便安装板材和其他部件。

07
45
系列

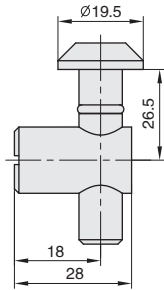

CAE-45-01

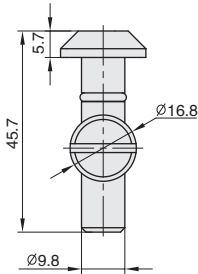

ex.
安装示例

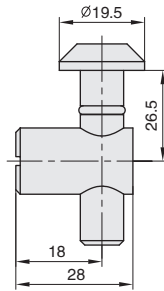
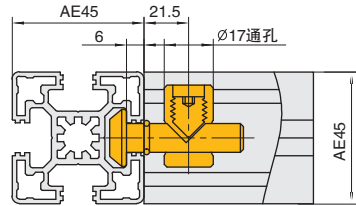

CAE-45-02

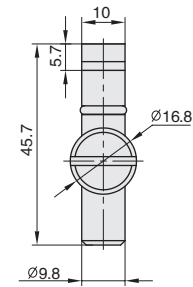

ex.
安装示例

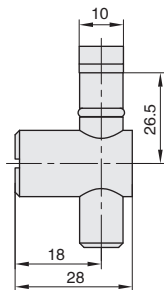
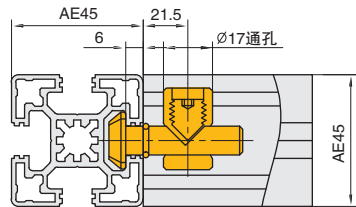

CAE-45-03

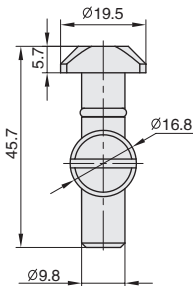

ex.
安装示例

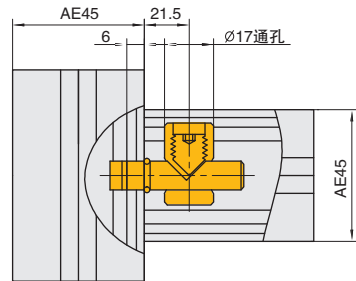

代号	类型	参考重量 (g)
CAE-45-01	任意角度	63
CAE-45-02	0 度	60
CAE-45-03	90 度	60