

# 内六角圆柱头轴肩螺钉

## 公差 e9



■公差 e9



① 代号	M 材质	S 表面处理	强度等级
DGLAE	SCM435	发黑	10.9
DGLBE	SUS304	—	A2-50

### 订购编号示例

① 代号	-	② D	-	③ L
DGLAE	-	D5	-	L10

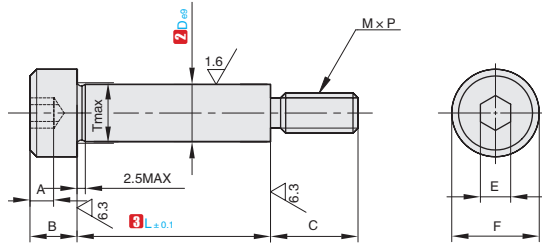

① 代号	② De9	③ L																						
DGLAE DGLBE	4	(10)	(15)	(20)	(25)	(30)	(35)	(40)	45															
	4.5	(10)	(15)	(20)	(25)	(30)	(35)	(40)	45	50														
	5	(10)	(15)	(20)	(25)	(30)	(35)	(40)	45	50														
	5.5	(10)	(15)	(20)	(25)	(30)	(35)	(40)	45	50	55													
	6	(10)	(15)	(20)	(25)	(30)	(35)	(40)	45	50	55	60	65	70										
	6.5	(10)	(15)	(20)	(25)	(30)	(35)	(40)	(45)	(50)	55	60	65	70	75	80								
	8	(10)	(15)	(20)	(25)	(30)	(35)	(40)	(45)	(50)	(55)	(60)	(65)	(70)	(75)	(80)	85	90	95	100	110	120		
	10	(10)	(15)	(20)	(25)	(30)	(35)	(40)	(45)	(50)	(55)	(60)	(65)	(70)	(75)	(80)	(85)	(90)	95	100	110	120		
	12	10	15	20	25	30	35	40	45	50	55	60	65	70	75	80	85	90	95	100				
	13	10	15	20	25	30	35	40	45	50	55	60	65	70	75	80	85	90	95	100	110	120	130	
	16	15	20	25	30	35	40	45	50	55	60	65	70	75	80	85	90	95	100	110	120	130	140	150
	20	40	50	60	70	80	90	100	110	120	130	140	150											

① 代号	② De9	C	F	E	A	B	M x P	T
DGLAE DGLBE	4	5	6.5	2.5	1.6	3	2.5×0.45	4.5
	4.5	6	7	2.5	1.6	3	3×0.5	5
	5	6	8	2.5	1.6	3.5	3×0.5	5.5
	5.5	7	9	3	2.2	4	4×0.7	6
	6	7	9	3	2	4	4×0.7	6.5
	6.5	9	10	4	2.5	5	5×0.8	7
	8	9	13	5	3	6	6×1.0	8.7
	10	12	16	6	4	8	8×1.25	10.8
	12	12	17	6	4	8	8×1.25	12.8
	13	16	18	8	5	10	10×1.5	14
	16	18	24	10	7	14	12×1.75	17
	20	14	27	14	9	18	16×2.0	21

▲ SUS304 材料只有 ( ) 内尺寸

F6  
垫片  
螺丝  
螺母  
吊环