

No. 6974

Centring clamp MINI with two clamping points

Double-acting,
max. operating pressure 350 bar,
min. operating pressure 10 bar.



CAD

Order no.	Article no.	Clamping force at 100 bar* [kN]	Clamping force at 350 bar* [kN]	Clamping points	Clamping Ø N -1	Stroke H [mm]	Repeatability [mm]	Q max. [l/min]	Weight [g]
329243	6974-2025	4,0	14,0	2	25-29	3,0	±0,02	1,0	440
329284	6974-2028	4,0	14,0	2	28-32	3,0	±0,02	1,0	447
329326	6974-2032	4,0	14,0	2	32-36	3,0	±0,02	1,0	456
329052	6974-2036	4,0	14,0	2	36-40	3,0	±0,02	1,0	574
329094	6974-2039	4,0	14,0	2	39-43	3,0	±0,02	1,0	590
329136	6974-2042	4,0	14,0	2	42-46	3,0	±0,02	1,0	604
329169	6974-2045	4,0	14,0	2	45-49	3,0	±0,02	1,0	620
329177	6974-2048	4,0	14,0	2	48-52	3,0	±0,02	1,0	635
329201	6974-2051	4,0	14,0	2	51-55	3,0	±0,02	1,0	652

* The clamping force is distributed centrally over the 2 clamping points.

Design:

Double-acting centring clamp with two clamping points.
All components from high-grade hardened and nitrided steel. Oil supply via oil channel in fixture body.

Application:

For centring and clamping workpieces with machined or cast holes, cutouts or penetrations.
Element screwed directly onto the fixture body, sealed with O-ring.

Features:

The centring clamp is fastened from below; oil is supplied through drilled channels in the fixture body. If the centring clamp is fastened from above and oil supplied through conduits drilled in the fixture body, a connection plate for O-ring connection is needed. If the centring clamp is fastened from above and oil supplied through pipes, a connection plate for pipe connection is needed.

Note:

The practical combination of 2-point and 3-point elements can avoid over-determined clamping states. Unsuitable for use on lathes.

On request:

Other sizes available on request.

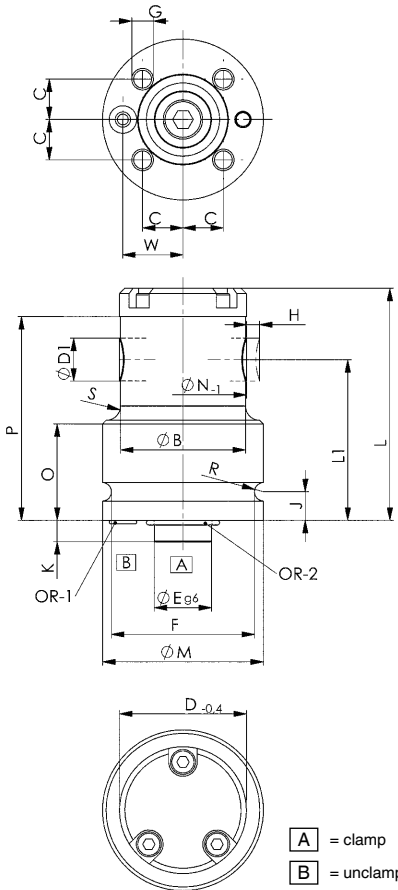

Installation dimensions:

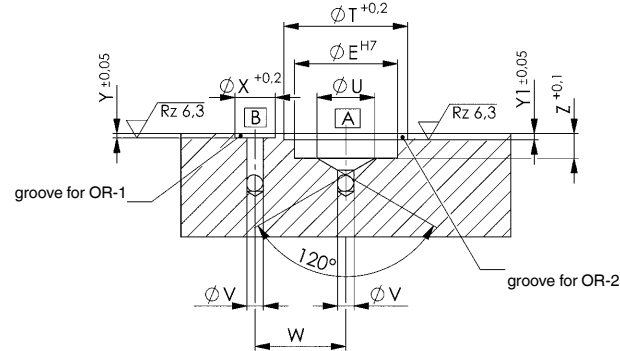

Dimensions:

Order no.	Article no.	dia. B	C	dia. D -0,4	Bolt Ø D1 [mm]	dia. E g6/h7	F	G	J	K	L	L1	dia. M	O	P	R	S	dia. T	dia. U	dia. V	W	dia. X	Y	Y1	Z	OR-1 O-ring Order No.	OR-2 O-ring Order No.
329243	6974-2025	24	11,3	24,5	12	16	40	M6x12	8	6	66,5	45	45	27	62,5	2,6	4,0	20,5	8	3	16,8	7,7	1,1	1,3	6	409508	537985
329284	6974-2028	24	11,3	27,5	12	16	40	M6x12	8	6	66,5	45	45	27	62,5	2,6	4,0	20,5	8	3	16,8	7,7	1,1	1,3	6	409508	537985
329326	6974-2032	24	11,3	31,5	12	16	40	M6x12	8	6	66,5	45	45	27	62,5	2,6	4,0	20,5	8	3	16,8	7,7	1,1	1,3	6	409508	537985
329052	6974-2036	35	11,3	35,5	12	16	40	M6x12	8	6	65,0	45	45	27	57,0	2,6	4,0	20,5	8	3	16,8	7,7	1,1	1,3	6	409508	537985
329094	6974-2039	35	11,3	38,5	12	16	40	M6x12	8	6	65,0	45	45	27	57,0	2,6	4,0	20,5	8	3	16,8	7,7	1,1	1,3	6	409508	537985
329136	6974-2042	35	11,3	41,5	12	16	40	M6x12	8	6	65,0	45	45	27	57,0	2,6	4,0	20,5	8	3	16,8	7,7	1,1	1,3	6	409508	537985
329169	6974-2045	35	11,3	44,5	12	16	40	M6x12	8	6	65,0	45	45	27	57,0	2,6	4,0	20,5	8	3	16,8	7,7	1,1	1,3	6	409508	537985
329177	6974-2048	35	11,3	47,5	12	16	40	M6x12	8	6	65,0	45	45	27	57,0	2,6	4,0	20,5	8	3	16,8	7,7	1,1	1,3	6	409508	537985
329201	6974-2051	35	11,3	50,5	12	16	40	M6x12	8	6	65,0	45	45	27	57,0	2,6	4,0	20,5	8	3	16,8	7,7	1,1	1,3	6	409508	537985

Subject to technical alterations.