

## No. 6210L

### Assembly element K10, K10.3 and K20, pneumatic

Housing: tempered steel, gas-nitrided and oxidised.  
Clamping module: cover and piston hardened.

Order no.	Size	Pull-in/locking force up to	Holding force*	Weight
		[kN]	[kN]	
534925	K10	8	25	2720
534537	K10.3	10	25	7708
534842	K20	17	55	7185

#### Application:

The assembly element is used to clamp with repetition accuracy workpieces or fixtures directly onto the pneumatic clamping modules K10, K10.3 and K20 via pull-studs.  
This clamping system can be used to move workpieces to the required machining height in the machine for 5-sided machining, or for the safe and quick clamping of workpieces with ledges and different clamping heights on the machine table.

#### Advantage:

Simple, quick and flexible clamping of complex workpiece contours on the machine table. Especially suitable for levelling workpieces or clamping fixtures at the necessary machine heights in the machine tool and for the reliable clamping of same.

#### Note:

Order no. for the centering sleeve  $\varnothing$  16 mm: 78006

The pneum. quick-release coupling, connector version, and the fastening screw are supplied as standard.

\* Please observe the installation instructions.

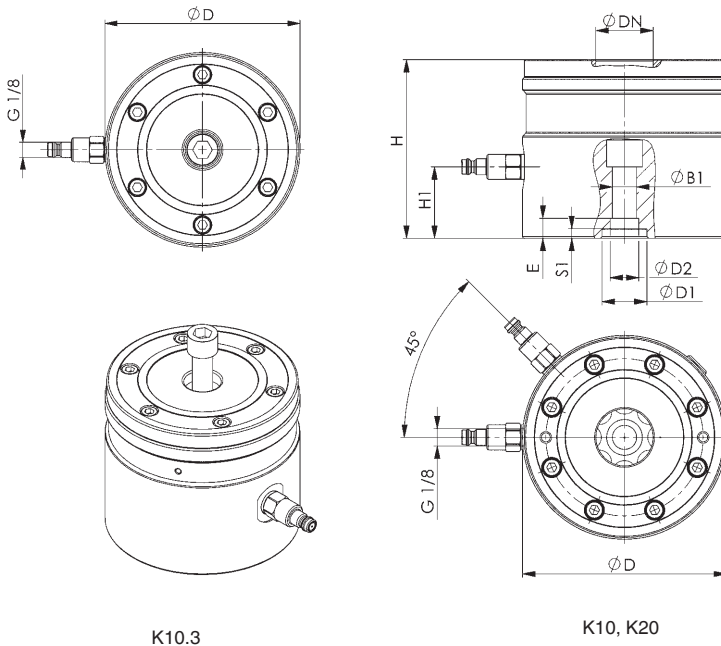

K10.3

K10, K20

#### Dimensions:

Order no.	Size	dia. B1	dia. D	dia. D1 0/+0,01	dia. D2 F7	dia. DN	E	H $\pm 0.01$	H1	S1
534925	K10	9,0	80	-	15	22	5,0	80	35	-
534537	K10.3	13,5	114	25	16	22	11,25	100	40	5,5
534842	K20	13,5	114	25	16	32	11,25	100	40	5,5

CAD



Subject to technical alterations.