



Anaconda Compact nickel plated brass fittings for Multiflex UI / UIG.

The nickel plated brass Anaconda fittings can be used with all types of Anaconda Multiflex (except RWA). This Anaconda fitting an universal fitting and offers great corrosion protection in combination with a nice appearance. By using the UIG/UI connection set consisting of a special turned ferrule and clamping ring, a very high pull-out strength is achieved. Next to the mentioned straight fittings, 90° fittings are also possible (see chapter 4). The connection sets will be supplied separately.

Material & Construction:

Construction: Nickel plated brass fitting, consisting of 4 parts (counter nut, clamping ring, ferrule and body).

Material: Counter nut, clamping ring, ferrule and body are nickel plated brass. Inserts are from PA6 (red for ISO metric, blue for Pg and white for NPT).

Temperature: -55 °C till +260 °C continuous.

Protection class: IP 40, (cable-hose fittings are IP 68 on the switchbox).

Colour: Metal.

ANACONDA
MULTIFLEX

Connection set, nickel plated brass, for combination with Multiflex type UIG / UI.



Thread	UIG/UI Size (inch)	Min. Internal Bore (mm)	Fitting thread size			Standard Package	Article Number	Weight (Kg/100)
			ISO	Pg	NPT			
-	3/8"	9,8	M16 x 1,5	Pg 11	1/2" NPT	25	817.213.9	2,0
-	1/2"	13,9	M20 x 1,5	Pg 16	1/2" NPT	25	817.216.9	2,4
-	3/4"	18,5	M25 x 1,5	Pg 21	3/4" NPT	25	817.220.9	3,8
-	1"	22,8	M32 x 1,5	Pg 29	1" NPT	25	817.226.9	4,0
-	1.1/4"	30,8	M40 x 1,5	Pg 36	1.1/4" NPT	25	817.235.9	9,8
-	1.1/2"	36,9	M50 x 1,5	Pg 42	1.1/2" NPT	25	817.240.6*	4,2
-	2"	47,9	M63 x 1,5	Pg 48	2" NPT	25	817.250.6*	9,0

* Set consists of a clamping ring only.

FITTINGS FOR
TYPE UIG / UI
IP 40

ISO straight compact fitting, male, nickel plated brass (including connection set).

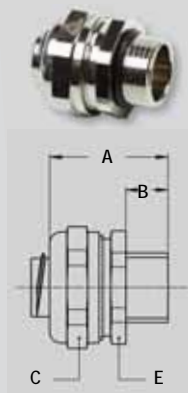

Thread	UIG/UI Size (inch)	Min. Internal Bore (mm)	Dimensions in mm					Standard Package	Article Number	Weight (Kg/100)
			A	B	C	D	E			
M16 x 1,5	3/8"	9,8	30	10	26	-	24	10	712.016.7	4,4
M20 x 1,5	3/8"	9,8	30	10	26	-	24	10	712.017.7	4,5
M20 x 1,5	1/2"	13,9	32	10	29	-	27	10	712.020.7	5,3
M25 x 1,5	3/4"	18,5	33	10	35	-	33	5	712.025.7	7,8
M32 x 1,5	1"	22,8	36	12	45	-	44	5	712.032.7	14,4
M40 x 1,5	1.1/4"	30,8	40	13	53	-	50	2	712.040.7	19,1
M50 x 1,5	1.1/2"	36,9	46	14	62	-	58	2	712.050.7	28,0
M63 x 1,5	2"	47,9	52	16	76	-	72	2	712.063.7	43,4

ISO straight swivel fitting, male, nickel plated brass
(including connection set).

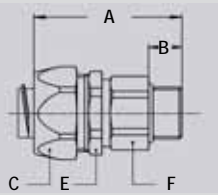

Thread	UIG/UI Size (inch)	Min. Internal Bore (mm)	Dimensions in mm					Standard Package	Article Number	Weight (Kg/100)
			A	B	C	D	E			
M16 x 1,5	3/8"	9,8	48	10	26	24	21	10	813.016.7	10,1
M20 x 1,5	1/2"	13,9	49	10	29	27	25	10	813.020.7	12,6
M25 x 1,5	3/4"	17,4	49	10	35	33	31	5	813.025.7	17,6
M32 x 1,5	1"	22,8	55	12	45	42	38	5	813.032.7	36,5
M40 x 1,5	1.1/4"	29,4	58	14	54	50	48	2	813.040.7	66,6
M50 x 1,5	1.1/2"	36,9	65	14	62	58	55	2	813.050.7	74,0
M63 x 1,5	2"	47,9	74	16	76	72	68	2	813.063.7	130,0

Pg straight compact fitting, male, nickel plated brass
(including connection set).

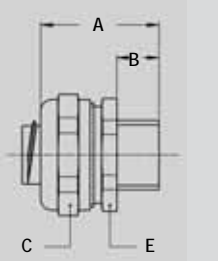

Thread	UIG/UI Size (inch)	Min. Internal Bore (mm)	Dimensions in mm					Standard Package	Article Number	Weight (Kg/100)
			A	B	C	D	E			
Pg 11	3/8"	9,8	30	10	26	-	24	10	710.011.7	4,8
Pg 13,5	3/8"	9,8	30	10	26	-	24	10	710.013.7	4,6
Pg 16	1/2"	13,9	32	10	29	-	27	10	710.016.7	5,3
Pg 21	3/4"	18,5	33	10	35	-	33	5	710.021.7	7,8
Pg 29	1"	22,8	36	12	45	-	44	5	710.029.7	14,4
Pg 36	1.1/4"	30,8	40	13	53	-	52	2	710.036.7	19,1
Pg 42	1.1/2"	36,9	46	14	62	-	60	2	710.042.7	29,4
Pg 48	2"	47,9	52	16	76	-	72	2	710.048.7	43,4

NPT straight compact fitting, male, nickel plated brass
(including connection set).

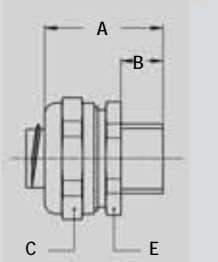

Thread	UIG/UI Size (inch)	Min. Internal Bore (mm)	Dimensions in mm					Standard Package	Article Number	Weight (Kg/100)
			A	B	C	D	E			
NPT 1/2"	3/8"	9,8	32	12	26	-	24	10	714.012.7	4,8
NPT 1/2"	1/2"	13,9	34	12	29	-	27	10	714.016.7	5,7
NPT 3/4"	3/4"	18,5	35	12	35	-	33	5	714.020.7	8,2
NPT 1"	1"	22,8	37	13	45	-	44	5	714.026.7	14,7
NPT 1.1/4"	1.1/4"	30,8	42	15	53	-	52	2	714.035.7	22,4
NPT 1.1/2"	1.1/2"	36,9	48	16	62	-	60	2	714.040.7	29,7
NPT 2"	2"	47,9	54	19	76	-	72	2	714.050.7	47,8

Conduit connector, nickel plated brass.

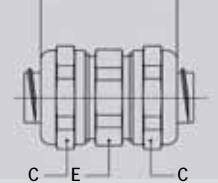

Thread	UIG/UI Size (inch)	Min. Internal Bore (mm)	Dimensions in mm					Standard Package	Article Number	Weight (Kg/100)
			A	B	C	D	E			
-	3/8"	9,8	41	-	26	-	24	10	784.012.7	11,4
-	1/2"	13,9	45	-	29	-	27	10	784.016.7	13,8
-	3/4"	18,5	48	-	35	-	33	5	784.020.7	20,6
-	1"	22,8	53	-	45	-	44	5	784.026.7	33,2
-	1.1/4"	30,8	58	-	53	-	50	2	784.035.7	52,2
-	1.1/2"	36,9	69	-	62	-	58	2	784.040.7	60,8
-	2"	47,9	78	-	76	-	72	2	784.050.7	94,7

ANACONDA
MULTIFLEX

FITTINGS FOR
TYPE UIG / UI
IP 40



Anaconda nickel plated brass fittings for Multiflex UIG / UI.

The nickel plated brass Anaconda fittings can be used with all types of Anaconda Multiflex (except RWA). This Anaconda fitting is the most used universal fitting and offers great corrosion protection in combination with a nice appearance. By using the UIG/UI connection set consisting of a special turned ferrule and clamping ring, a very high pull-out strength is achieved. Next to the mentioned straight fittings, 45°/ 90° fittings as well as stainless steel fittings (up to +600 °C) are also possible (see chapter 4 & 6). The connection sets will be supplied separately.

Material & Construction:

Construction: Nickel plated brass fitting, consisting of 4 parts (counter nut, clamping ring, ferrule and body).

Material: Counter nut, clamping ring, ferrule and body are nickel plated brass. Inserts are from PA6 (red for ISO metric, blue for Pg and white for NPT).

Temperature: -55 °C till +260 °C continuous (for cable-hose fittings with NBR seal -40 °C till +260 °C).

Protection class: IP 40, (cable-hose fittings are IP 68 on the switchbox).

Colour: Metal.

ANACONDA
MULTIFLEX

Connection set, nickel plated brass, for combination with Multiflex type UIG / UI.



Thread	UIG/UI	Min. Internal Bore (mm)	Fitting thread size			Standard Package	Article Number	Weight (Kg/100)
	Size (inch)		ISO	Pg	NPT			
-	5/16"	6,8	M16 x 1,5	Pg 9	1/2" NPT	10	817.210.9	2,2
-	3/8"	9,8	M16 x 1,5	Pg 11	1/2" NPT	10	817.213.9	2,0
-	1/2"	13,9	M20 x 1,5	Pg 16	1/2" NPT	10	817.216.9	2,4
-	3/4"	18,5	M25 x 1,5	Pg 21	3/4" NPT	5	817.220.9	3,8
-	1"	22,8	M32 x 1,5	Pg 29	1" NPT	5	817.226.9	4,0
-	1.1/4"	30,8	M40 x 1,5	Pg 36	1.1/4" NPT	2	817.235.9	9,8
-	1.1/2"	36,8	M50 x 1,5	Pg 42	1.1/2" NPT	2	817.240.9	12,4
-	2"	47,8	M63 x 1,5	Pg 48	2" NPT	2	817.250.9	18,2

FITTINGS FOR
TYPE UIG / UI
IP 40

ISO straight fitting, male, nickel plated brass (including connection set).

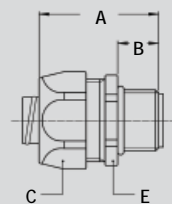

Thread	UIG/UI	Min. Internal Bore (mm)	Dimensions in mm					Standard Package	Article Number	Weight (Kg/100)
	Size (inch)		A	B	C	D	E			
M16 x 1,5	5/16"	6,8	35	12	26	-	24	10	812.015.7	6,2
M20 x 1,5	5/16"	6,8	36	13	26	-	24	10	812.014.7	6,5
M16 x 1,5	3/8"	9,8	35	12	26	-	24	10	812.016.7	6,4
M20 x 1,5	3/8"	9,8	36	13	26	-	24	10	812.017.7	6,7
M20 x 1,5	1/2"	13,9	37	13	29	-	27	10	812.020.7	7,7
M25 x 1,5	3/4"	18,5	40	15	35	-	33	5	812.025.7	10,9
M32 x 1,5	1"	22,8	46	15	45	-	43	5	812.032.7	20,1
M40 x 1,5	1.1/4"	30,8	52	16	54	-	52	2	812.040.7	31,7
M50 x 1,5	1.1/2"	36,8	56	18	63	-	60	2	812.050.7	47,9
M63 x 1,5	2"	47,8	66	20	77	-	74	2	812.063.7	82,9

ISO straight fitting, female, nickel plated brass
(including connection set).

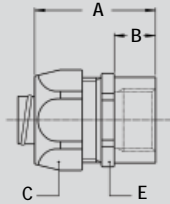

Thread	UIG/UI Size (inch)	Min. Internal Bore (mm)	Dimensions in mm					Standard Package	Article Number	Weight (Kg/100)
			A	B	C	D	E			
M16 x 1,5	5/16"	6,8	35	12	26	-	24	10	812.315.7	6,4
M16 x 1,5	3/8"	9,8	35	12	26	-	24	10	812.316.7	6,6
M20 x 1,5	1/2"	13,9	37	13	29	-	27	10	812.320.7	9,4
M25 x 1,5	3/4"	18,5	40	15	35	-	33	5	812.325.7	12,0
M32 x 1,5	1"	22,8	46	15	45	-	43	5	812.332.7	20,9
M40 x 1,5	1.1/4"	30,8	52	16	54	-	52	2	812.340.7	33,1
M50 x 1,5	1.1/2"	36,8	56	18	63	-	60	2	812.350.7	46,8
M63 x 1,5	2"	47,8	66	20	77	-	74	2	812.363.7	81,2

ISO 90° fitting, male, nickel plated brass
(including connection set).

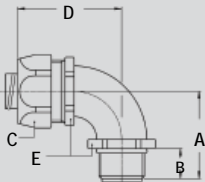

Thread	UIG/UI Size (inch)	Min. Internal Bore (mm)	Dimensions in mm					Standard Package	Article Number	Weight (Kg/100)
			A	B	C	D	E			
M16 x 1,5	5/16"	6,8	32	12	26	42	22	10	812.915.7	9,6
M20 x 1,5	5/16"	6,8	33	13	26	42	22	10	812.914.7	9,8
M16 x 1,5	3/8"	9,8	32	12	26	42	22	10	812.916.7	9,8
M20 x 1,5	3/8"	9,8	33	13	26	42	22	10	812.917.7	10,0
M20 x 1,5	1/2"	13,9	36	13	29	43	27	10	812.920.7	14,4
M25 x 1,5	3/4"	18,5	43	15	35	48	33	5	812.925.7	22,2
M32 x 1,5	1"	22,8	48	15	45	59	42	5	812.932.7	34,2
M40 x 1,5	1.1/4"	30,8	57	16	54	68	51	2	812.940.7	59,9
M50 x 1,5	1.1/2"	36,8	63	18	63	78	60	2	812.950.7	90,9
M63 x 1,5	2"	47,8	74	20	77	96	74	2	812.963.7	149,2

ISO cable-hose fitting, male, nickel plated brass
(including connection set).

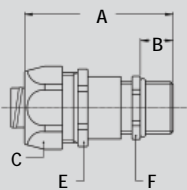

Thread	UI/UIG Size (inch)	Clamping Range (mm)	Dimensions in mm					Standard Package	Article Number	Weight (Kg/100)
			A	B	C	E	F			
M16 x 1,5	5/16"	4 - 6,8	57	12	26	24	18	10	812.715.7	7,4
M16 x 1,5	3/8"	4 - 8	57	12	26	24	18	10	812.716.7	9,4
M20 x 1,5	3/8"	6 - 9,8	57	12	26	24	22	10	812.717.7	11,1
M20 x 1,5	1/2"	6 - 12	59	12	29	27	22	10	812.720.7	11,5
M25 x 1,5	1/2"	10 - 13,9	62	12	29	27	27	5	812.722.7	13,5
M32 x 1,5	3/4"	13 - 18	70	15	35	33	34	5	812.728.7	23,2
M40 x 1,5	1"	18 - 22,8	83	15	45	43	43	2	812.735.7	35,2
M50 x 1,5	1.1/4"	22 - 30,8	96	15	54	52	55	2	812.745.7	69,8

ISO cable-hose fitting, male, nickel plated brass, silicone
insert up to max +260 °C (including connection set).

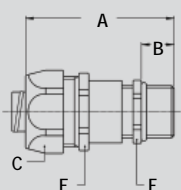

Thread	UI/UIG Size (inch)	Clamping Range (mm)	Dimensions in mm					Standard Package	Article Number	Weight (Kg/100)
			A	B	C	E	F			
M16 x 1,5	5/16"	4 - 6	50	5	26	24	18	10	812.715.4	7,4
M16 x 1,5	3/8"	4 - 9	50	5	26	24	18	10	812.716.4	9,4
M20 x 1,5	1/2"	4,5 - 12	53	6	29	27	22	10	812.720.4	11,5
M25 x 1,5	1/2"	10 - 13	57	7	29	27	28	5	812.722.4	13,5

ANACONDA
MULTIFLEX

FITTINGS FOR
TYPE UIG / UI
IP 40

ISO, EMC-cable-hose fitting, male, nickel plated brass
(including connection set).

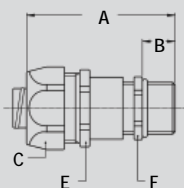

Thread	UIG/UI Size (inch)	Clamping Range (mm)	Dimensions in mm					Standard Package	Article Number	Weight (Kg/100)
			A	B	C	E	F			
M16 x 1,5	5/16"	4 - 6,8	57	12	26	24	18	10	812.615.7	7,4
M16 x 1,5	3/8"	4 - 8	57	12	26	24	18	10	812.616.7	9,4
M20 x 1,5	3/8"	6 - 9,8	57	12	26	24	22	10	812.617.7	11,1
M20 x 1,5	1/2"	6 - 12	59	12	29	27	22	10	812.620.7	11,5
M25 x 1,5	1/2"	10 - 13,9	62	12	29	27	27	5	812.622.7	13,5
M32 x 1,5	3/4"	13 - 18	70	15	35	33	34	5	812.628.7	22,6
M40 x 1,5	1"	18 - 22,8	83	15	45	43	43	2	812.635.7	38,0

Pg straight fitting, male, nickel plated brass
(including connection set).

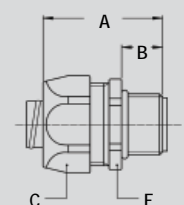

Thread	UIG/UI Size (inch)	Min. Internal Bore (mm)	Dimensions in mm					Standard Package	Article Number	Weight (Kg/100)
			A	B	C	D	E			
Pg 9	5/16"	6,8	35	12	26	-	24	10	810.009.7	6,4
Pg 11	5/16"	6,8	35	12	26	-	24	10	810.012.7	7,2
Pg 9	3/8"	9,8	35	12	26	-	24	10	810.010.7	6,4
Pg 11	3/8"	9,8	35	12	26	-	24	10	810.011.7	7,2
Pg 13,5	3/8"	9,8	35	12	26	-	24	10	810.013.7	7,2
Pg 16	1/2"	13,9	37	13	29	-	27	10	810.016.7	8,1
Pg 21	3/4"	18,5	40	15	35	-	33	5	810.021.7	11,4
Pg 29	1"	22,8	46	15	45	-	43	5	810.029.7	27,6
Pg 36	1.1/4"	30,8	52	16	54	-	52	2	810.036.7	38,4
Pg 42	1.1/2"	36,8	56	18	63	-	60	2	810.042.7	52,8
Pg 48	2"	47,8	66	20	77	-	74	2	810.048.7	81,4

Pg straight fitting, female, nickel plated brass
(including connection set).

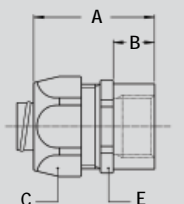

Thread	UIG/UI Size (inch)	Min. Internal Bore (mm)	Dimensions in mm					Standard Package	Article Number	Weight (Kg/100)
			A	B	C	D	E			
Pg 11	5/16"	6,8	35	12	26	-	24	10	810.312.7	6,7
Pg 11	3/8"	9,8	35	12	26	-	24	10	810.311.7	6,9
Pg 13,5	5/16"	6,8	35	12	26	-	24	10	810.314.7	7,2
Pg 13,5	3/8"	9,8	35	12	26	-	24	10	810.313.7	7,4
Pg 16	1/2"	13,9	37	13	29	-	27	10	810.316.7	8,1
Pg 21	3/4"	18,5	40	15	35	-	33	5	810.321.7	12,3
Pg 29	1"	22,8	46	15	45	-	43	5	810.329.7	23,3
Pg 36	1.1/4"	30,8	52	16	54	-	52	2	810.336.7	33,1
Pg 42	1.1/2"	36,8	56	18	63	-	60	2	810.342.7	48,8
Pg 48	2"	47,8	66	20	77	-	74	2	810.348.7	84,2

Pg straight swivel fitting, male, nickel plated brass
(including connection set).

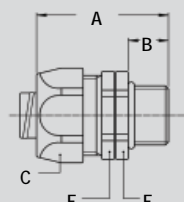

Thread	UIG/UI Size (inch)	Min. Internal Bore (mm)	Dimensions in mm					Standard Package	Article Number	Weight (Kg/100)
			A	B	C	D	E			
Pg 9	5/16"	6,8	41	12	26	-	24	10	811.009.7	8,2
Pg 11	3/8"	9,8	41	12	26	-	24	10	811.011.7	8,4
Pg 16	1/2"	13,9	43	13	29	-	27	10	811.016.7	10,6
Pg 21	3/4"	18,5	48	15	35	-	33	5	811.021.7	16,6
Pg 29	1"	22,8	54	15	45	-	43	5	811.029.7	30,0

ANACONDA
MULTIFLEX

FITTINGS FOR
TYPE UIG / UI
IP 40

**Pg 90° fitting, male, nickel plated brass
(including connection set).**

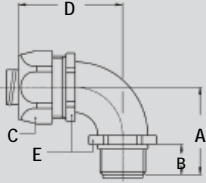

Thread	UIG/UI Pg	Min. Internal Bore (mm)	Dimensions in mm					Standard Package	Article Number	Weight (Kg/100)
			A	B	C	D	E			
Pg 11	5/16"	6,8	32	12	26	42	22	10	810.912.7	10,3
Pg 13,5	5/16"	6,8	32	12	26	42	22	10	810.914.7	10,3
Pg 11	3/8"	9,8	32	12	26	42	22	10	810.911.7	10,5
Pg 13,5	3/8"	9,8	32	12	26	42	22	10	810.913.7	10,5
Pg 16	1/2"	13,9	36	13	29	43	27	10	810.916.7	17,1
Pg 21	3/4"	18,5	43	15	35	48	33	5	810.921.7	24,6
Pg 29	1"	22,8	48	15	45	59	42	5	810.929.7	37,9
Pg 36	1.1/4"	30,8	57	16	54	68	51	2	810.936.7	66,3
Pg 42	1.1/2"	36,8	63	18	63	78	60	2	810.942.7	93,7
Pg 48	2"	47,8	74	20	77	96	74	2	810.948.7	151,3

**Pg cable-hose fitting, male, nickel plated brass
(including connection set).**

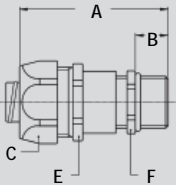

Thread	UIG/UI Pg	Clamping Range (mm)	Dimensions in mm					Standard Package	Article Number	Weight (Kg/100)
			A	B	C	E	F			
Pg 9	5/16"	4 - 6,8	55	10	26	24	17	10	810.709.7	9,2
Pg 9	3/8"	5 - 8	55	10	26	24	20	10	810.712.7	9,4
Pg 11	3/8"	5 - 9,8	55	10	26	24	20	10	810.711.7	11,1
Pg 13,5	1/2"	6 - 12	57	10	29	27	22	10	810.715.7	11,5
Pg 16	1/2"	10 - 13,9	60	10	29	27	24	10	810.716.7	13,5
Pg 21	3/4"	13 - 18	67	12	35	33	30	5	810.721.7	22,6
Pg 29	1"	18 - 22,8	80	12	45	43	40	5	810.729.7	38,0

**Pg cable-hose fitting, male, nickel plated brass, silicone
insert up to max +260 °C (including connection set).**

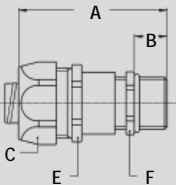

Thread	UIG/UI Pg	Clamping Range (mm)	Dimensions in mm					Standard Package	Article Number	Weight (Kg/100)
			A	B	C	E	F			
Pg 11	3/8"	5 - 9,8	51	6	26	24	22	10	810.711.4	11,1
Pg 13,5	1/2"	8 - 12	54	7	29	27	24	10	810.715.4	11,5
Pg 16	1/2"	8 - 13,9	56	6	29	27	24	10	810.716.4	13,5
Pg 21	3/4"	10 - 18	62	7	35	33	32	5	810.721.4	22,6

**ANACONDA
MULTIFLEX**

**FITTINGS FOR
TYPE UIG / UI
IP 40**

**NPT straight fitting, male, nickel plated brass
(including connection set).**

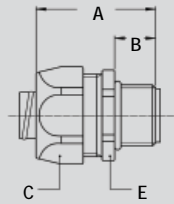

Thread NPT	UIG/UI Size (inch)	Min. Internal Bore (mm)	Dimensions in mm					Standard Package	Article Number	Weight (Kg/100)
			A	B	C	D	E			
1/2" NPT	5/16"	6,8	35	12	26	-	24	10	814.011.7	7,0
1/2" NPT	3/8"	9,8	35	12	26	-	24	10	814.012.7	7,2
1/2" NPT	1/2"	13,9	37	13	29	-	27	10	814.016.7	8,0
3/4" NPT	3/4"	18,5	40	15	35	-	33	5	814.020.7	11,9
1" NPT	1"	22,8	46	15	45	-	43	5	814.026.7	27,6
1.1/4" NPT	1.1/4"	30,8	52	16	54	-	52	2	814.035.7	43,8
1.1/2" NPT	1.1/2"	36,8	56	18	63	-	60	2	814.040.7	49,4
2" NPT	2"	47,8	66	20	77	-	74	2	814.050.7	82,9

**NPT straight fitting, female, nickel plated brass
(including connection set).**

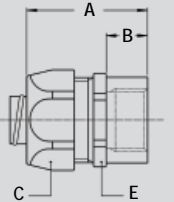

Thread NPT	UIG/UI Size (inch)	Min. Internal Bore (mm)	Dimensions in mm					Standard Package	Article Number	Weight (Kg/100)
			A	B	C	D	E			
1/2" NPT	5/16"	6,8	37	13	26	-	24	10	814.311.7	6,7
1/2" NPT	3/8"	9,8	37	13	26	-	24	10	814.312.7	6,9
1/2" NPT	1/2"	13,9	37	13	29	-	27	10	814.316.7	8,0
3/4" NPT	3/4"	18,5	40	15	35	-	33	5	814.320.7	12,0
1" NPT	1"	22,8	46	15	45	-	43	5	814.326.7	23,3
1.1/4" NPT	1.1/4"	30,8	52	16	54	-	52	2	814.335.7	33,1
1.1/2" NPT	1.1/2"	36,8	56	18	63	-	60	2	814.340.7	49,4
2" NPT	2"	47,8	66	20	77	-	74	2	814.350.7	82,7

**NPT 90° fitting, male, nickel plated brass
(including connection set).**

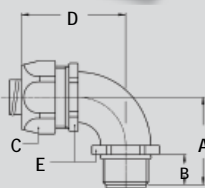

Thread NPT	UIG/UI Size (inch)	Min. Internal Bore (mm)	Dimensions in mm					Standard Package	Article Number	Weight (Kg/100)
			A	B	C	D	E			
1/2" NPT	5/16"	6,8	32	12	26	42	22	10	814.911.7	14,7
1/2" NPT	3/8"	9,8	32	12	26	42	22	10	814.912.7	14,9
1/2" NPT	1/2"	13,9	36	13	29	43	27	10	814.916.7	16,4
3/4" NPT	3/4"	18,5	43	15	35	48	33	5	814.920.7	25,0
1" NPT	1"	22,8	48	15	45	59	42	5	814.926.7	34,3
1.1/4" NPT	1.1/4"	30,8	57	16	54	68	51	2	814.935.7	66,3
1.1/2" NPT	1.1/2"	36,8	63	18	63	78	60	2	814.940.7	94,7
2" NPT	2"	47,8	74	20	77	96	74	2	814.950.7	151,3

**NPT cable-hose fitting, male, nickel plated brass
(including connection set).**

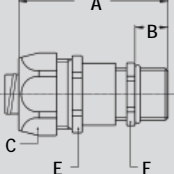

Thread NPT	UIG/UI Size (inch)	Clamping Range (mm)	Dimensions in mm					Standard Package	Article Number	Weight (Kg/100)
			A	B	C	E	F			
3/8" NPT	5/16"	4 - 6,8	60	15	26	24	17	10	814.709.7	9,2
3/8" NPT	3/8"	4 - 8	60	15	26	24	17	10	814.710.7	9,4
1/2" NPT	3/8"	6 - 9,8	57	13	26	24	22	10	814.712.7	13,3
1/2" NPT	1/2"	6 - 12	59	13	29	27	22	10	814.715.7	13,5
3/4" NPT	3/4"	13 - 18	68	13	35	33	30	5	814.721.7	22,6

**ANACONDA
MULTIFLEX**

**FITTINGS FOR
TYPE UIG / UI
IP 40**



Anaconda stainless steel fittings for Multiflex UI.

The stainless steel Anaconda fittings can be used with all types of Anaconda Multiflex (except RWA). This Anaconda fitting offers superior corrosion protection in combination with a nice appearance. By using the UIG/UI connection set consisting of a special turned ferrule and clamping ring, a very high pull-out strength is achieved. The standard stainless steel fittings are AISI-303 or AISI-316.

The connection set can be combined with all types of stainless steel Anaconda fittings and will be supplied separately.

Material & Construction:

Construction: Stainless steel (AISI-303 or AISI-316) fitting, consisting of 4 parts (counter nut, clamping ring, ferrule and body).

Material: Counter nut and body are stainless steel (AISI-303 or AISI-316), clamping ring and ferrule are nickel plated brass. Inserts are from PA6 (red for ISO metric, blue for Pg and white for NPT).

Temperature: -55 °C till +260 °C continuous.

Protection class: IP 40, (cable-hose fittings are IP 68 on the switchbox).

Colour: Metal.

ANACONDA
MULTIFLEX

Connection set, nickel plated brass, for combination with Multiflex type UI.



Thread	UI	Min. Internal Bore (mm)	Fitting thread size			Standard Package	Article Number	Weight (Kg/100)
	Size (inch)		ISO	Pg	NPT			
-	5/16"	6,8	M16 x 1,5	Pg 9	1/2" NPT	10	817.210.9	2,2
-	3/8"	9,8	M16 x 1,5	Pg 11	1/2" NPT	10	817.213.9	2,0
-	1/2"	13,9	M20 x 1,5	Pg 16	1/2" NPT	10	817.216.9	2,4
-	3/4"	18,5	M25 x 1,5	Pg 21	3/4" NPT	5	817.220.9	3,8
-	1"	22,8	M32 x 1,5	Pg 29	1" NPT	5	817.226.9	4,0
-	1.1/4"	30,8	M40 x 1,5	Pg 36	1.1/4" NPT	2	817.235.9	9,8
-	1.1/2"	36,8	M50 x 1,5	Pg 42	1.1/2" NPT	2	817.240.9	12,4
-	2"	47,8	M63 x 1,5	Pg 48	2" NPT	2	817.250.9	18,2

FITTINGS FOR
TYPE UI
IP 40

ISO straight fitting, male, stainless steel (AISI-303) (including connection set).

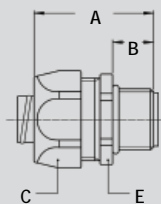

Thread	UI	Min. Internal Bore (mm)	Dimensions in mm					Standard Package	Article Number	Weight (Kg/100)
	Size (inch)		A	B	C	D	E			
M16 x 1,5	5/16"	6,8	35	12	27	-	24	10	812.015.8	6,2
M20 x 1,5	5/16"	6,8	36	13	27	-	24	10	812.014.8	6,5
M16 x 1,5	3/8"	9,8	35	12	27	-	24	10	812.016.8	6,4
M20 x 1,5	3/8"	9,8	36	13	27	-	24	10	812.017.8	6,7
M20 x 1,5	1/2"	13,9	37	13	30	-	27	10	812.020.8	7,7
M25 x 1,5	3/4"	18,5	40	15	36	-	36	5	812.025.8	10,9
M32 x 1,5	1"	22,8	46	15	46	-	46	5	812.032.8	20,1
M40 x 1,5	1.1/4"	30,8	52	16	54	-	52	2	812.040.8	31,7
M50 x 1,5	1.1/2"	36,8	56	18	63	-	60	2	812.050.8	47,9

ISO 90° fitting, male, stainless steel (AISI-303)
(including connection set).

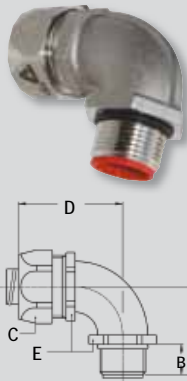

Thread	UI	Min. Internal Bore (mm)	Dimensions in mm					Standard Package	Article Number	Weight (Kg/100)
			A	B	C	D	E			
M16 x 1,5	5/16"	6,8	32	12	27	42	22	10	812.915.8	9,6
M20 x 1,5	5/16"	6,8	33	13	27	42	22	10	812.914.8	9,8
M16 x 1,5	3/8"	9,8	32	12	27	42	22	10	812.916.8	9,8
M20 x 1,5	3/8"	9,8	33	13	27	42	22	10	812.917.8	10,0
M20 x 1,5	1/2"	13,9	36	13	30	43	27	10	812.920.8	14,4
M25 x 1,5	3/4"	18,5	43	15	36	48	33	5	812.925.8	22,2

ISO cable-hose fitting, male, stainless steel (AISI-303)
(including connection set).

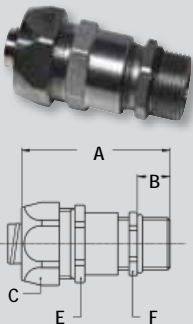

Thread	UI	Clamping Range (mm)	Dimensions in mm					Standard Package	Article Number	Weight (Kg/100)
			A	B	C	E	F			
M16 x 1,5	5/16"	4 - 6,8	57	12	27	24	18	10	812.715.8	7,4
M16 x 1,5	3/8"	4 - 8	57	12	27	24	18	10	812.716.8	9,4
M20 x 1,5	3/8"	6 - 9,8	57	12	27	24	22	10	812.717.8	11,1
M20 x 1,5	1/2"	6 - 12	59	12	30	27	22	10	812.720.8	11,5

Pg straight fitting, male, stainless steel (AISI-303)
(including connection set).

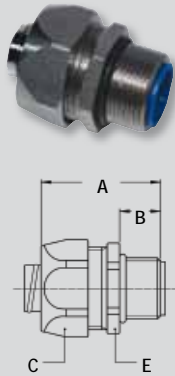

Thread	UI	Min. Internal Bore (mm)	Dimensions in mm					Standard Package	Article Number	Weight (Kg/100)
			A	B	C	D	E			
Pg 11	5/16"	6,8	35	12	27	-	24	10	810.012.8	7,2
Pg 11	3/8"	9,8	35	12	27	-	24	10	810.011.8	7,2
Pg 13,5	5/16"	6,8	35	12	27	-	24	10	810.014.8	7,2
Pg 13,5	3/8"	9,8	35	12	27	-	24	10	810.013.8	7,2
Pg 16	1/2"	13,9	37	13	30	-	27	10	810.016.8	8,1
Pg 21	3/4"	18,5	40	15	36	-	36	5	810.021.8	11,4
Pg 29	1"	22,8	46	15	46	-	46	5	810.029.8	27,6
Pg 36	1.1/4"	30,8	52	16	54	-	52	2	810.036.8	38,4
Pg 42	1.1/2"	36,8	56	18	63	-	60	2	810.042.8	52,8
Pg 48	2"	47,8	66	20	77	-	74	2	810.048.8	81,4

Pg 90° fitting, male, stainless steel (AISI-303)
(including connection set).

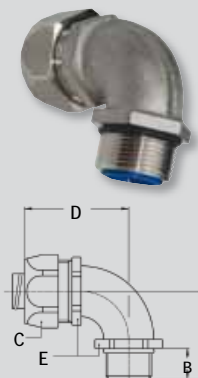

Thread	UI	Min. Internal Bore (mm)	Dimensions in mm					Standard Package	Article Number	Weight (Kg/100)
			A	B	C	D	E			
Pg 11	5/16"	6,8	32	12	27	42	22	10	810.912.8	10,3
Pg 11	3/8"	9,8	32	12	27	42	22	10	810.911.8	10,3
Pg 16	1/2"	13,9	36	13	30	43	27	10	810.916.8	17,1
Pg 21	3/4"	18,5	43	15	36	48	33	5	810.921.8	24,6
Pg 29	1"	22,8	48	15	46	59	42	5	810.929.8	37,9

ANACONDA
MULTIFLEX

FITTINGS FOR
TYPE UI
IP 40

NPT straight fitting, male, stainless steel (AISI-303)
(including connection set).

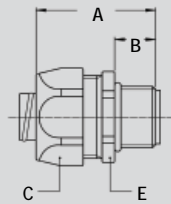

Thread	UI Size (inch)	Min. Internal Bore (mm)	Dimensions in mm					Standard Package	Article Number	Weight (Kg/100)
			A	B	C	D	E			
1/2" NPT	5/16"	6,8	35	12	27	-	24	10	814.011.8	7,0
1/2" NPT	3/8"	9,8	35	12	27	-	24	10	814.012.8	7,2
1/2" NPT	1/2"	13,9	37	13	30	-	27	10	814.016.8	8,0
3/4" NPT	3/4"	18,5	40	15	36	-	36	5	814.020.8	11,9
1" NPT	1"	22,8	46	15	46	-	46	5	814.026.8	27,6

NPT 90° fitting, male, stainless steel (AISI-303)
(including connection set).

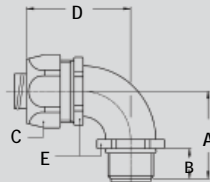

Thread	UI Size (inch)	Min. Internal Bore (mm)	Dimensions in mm					Standard Package	Article Number	Weight (Kg/100)
			A	B	C	D	E			
1/2" NPT	5/16"	6,8	32	12	27	42	22	10	814.911.8	14,7
1/2" NPT	3/8"	9,8	32	12	27	42	22	10	814.912.8	14,9
1/2" NPT	1/2"	13,9	36	13	30	43	27	10	814.916.8	16,4
3/4" NPT	3/4"	18,5	43	15	36	48	33	5	814.920.8	25,0
1" NPT	1"	22,8	48	15	46	59	42	5	814.926.8	34,3

ANACONDA
MULTIFLEX

FITTINGS FOR
TYPE UI
IP 40



Anaconda AISI-316 stainless steel fittings for Multiflex UI.

The stainless steel Anaconda fittings can be used with all types of Anaconda Multiflex (except RWA). This Anaconda fitting offers superior corrosion protection in combination with a nice appearance. By using the UIG/UI connection set consisting of a special turned ferrule and clamping ring, a very high pull-out strength is achieved. The standard stainless steel fittings are AISI-316.

The connection set can be combined with all types of stainless steel Anaconda fittings and will be supplied separately.

Material & Construction:

Construction: Stainless steel (AISI-316) fitting, consisting of 4 parts (counter nut, clamping ring, ferrule and body).

Material: Counter nut and body are stainless steel (AISI-316), clamping ring and ferrule are nickel plated brass. Inserts are from PA6 (red for ISO metric, blue for Pg and white for NPT).

Temperature: -55 °C till +260 °C continuous.

Protection class: IP 40.

Colour: Metal.

ISO straight fitting, male, stainless steel (AISI-316) (including connection set).

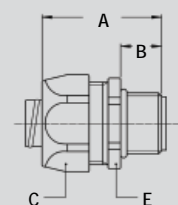

Thread	UI	Min. Internal Bore (mm)	Dimensions in mm					Standard Package	Article Number	Weight (Kg/100)
			A	B	C	D	E			
M16 x 1,5	3/8"	9,8	35	12	27	-	24	10	812.116.8	6,4
M20 x 1,5	1/2"	13,9	37	13	30	-	27	10	812.120.8	7,7
M25 x 1,5	3/4"	18,5	40	15	36	-	36	5	812.125.8	10,9

Pg straight fitting, male, stainless steel (AISI-316) (including connection set).



Thread	UI	Min. Internal Bore (mm)	Dimensions in mm					Standard Package	Article Number	Weight (Kg/100)
			A	B	C	D	E			
Pg 16	1/2"	13,9	37	13	30	-	27	10	810.116.8	8,1
Pg 21	3/4"	18,5	40	15	36	-	36	5	810.121.8	11,4
Pg 29	1"	22,8	46	15	46	-	43	5	810.129.8	27,6

NPT straight fitting, male, stainless steel (AISI-316) (including connection set).

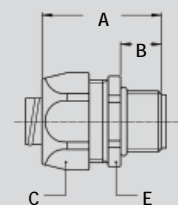

Thread	UI	Min. Internal Bore (mm)	Dimensions in mm					Standard Package	Article Number	Weight (Kg/100)
			A	B	C	D	E			
1/2" NPT	3/8"	9,8	37	13	27	-	24	10	814.112.8	7,2
1/2" NPT	1/2"	13,9	37	13	30	-	27	10	814.116.8	8,0
3/4" NPT	3/4"	18,5	40	15	36	-	36	5	814.120.8	11,9
1" NPT	1"	22,8	46	15	46	-	43	5	814.126.8	27,6