

Dimensions

- GRC basic type
- GRC-K high accuracy type

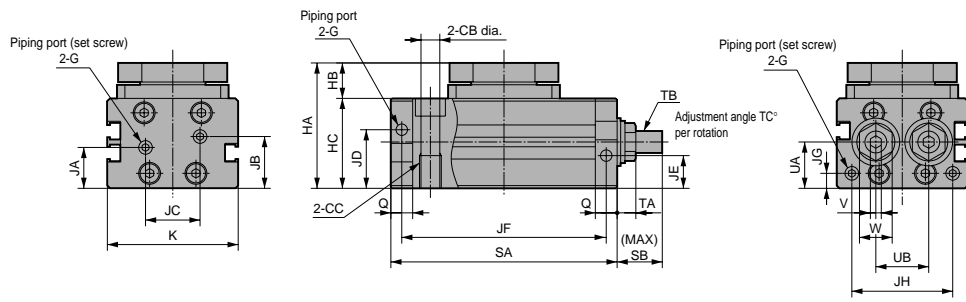

(File name: Page 55 or Ending 153 to 154)

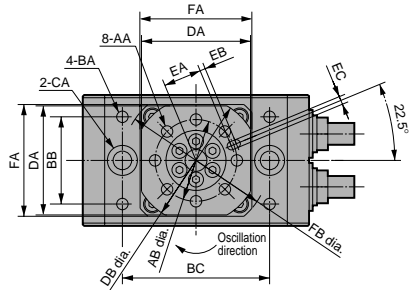

GRC-5

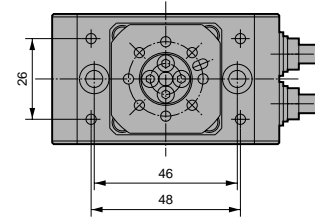

Positions of 4-BA and 2-CA differ for GRC-5 only.

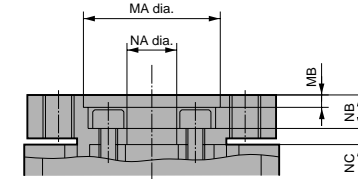
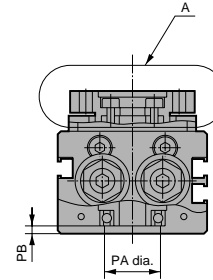

Section A details

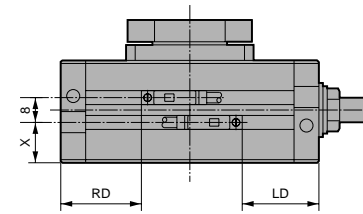

Switch installation position

Size	AA	AB	BA	BB	BC	CA	CB	CC	DA	DB	EA	EB	EC	FA	FB	G	HA	HB	HC	JA	JB	JC	JD	JE	JF		JG	JH	K	MA	MB	NA	NB	NC	PA	PB	Q
																									90°	180°											
5	M4 Depth 7	24	M4 Depth 6.5	26	48	Spot face 9.5 dia. Depth 5.4	5.2	M6 Depth 12	35	42	11	2	3 ^{+0.07} _{-0.02} depth 3.5	36	48h9	M5	43	13	30	15	18	16	21	11.5	65	82	5.6	29	42	17H9	2	4H9	5.5	2.4	12H9	3.5	8
10	M5 Depth 7	30	M5 Depth 7	32	54	Spot face 11 dia. Depth 6.5	6.6	M8 Depth 12	40	46	14	2	3 ^{+0.07} _{-0.02} depth 3.5	41	54h9	M5	46	13	33	15	19	20	21.5	12	75	99	5.6	37	48	22H9	2	8H9	5.5	2.4	18H9	2.5	8
20	M6 Depth 9	36	M6 Depth 8	42	62	Spot face 11 dia. Depth 6.5	6.9	M8 Depth 12	47	55	17	2	4 ^{+0.07} _{-0.02} depth 4.5	48	64h9	M5	53	16	37	14.5	20.5	27	22	13	86	115	5.6	47	58	27H9	2	11H9	6.5	3.9	20H9	2.5	10
30	M6 Depth 9	44	M6 Depth 8	52	74	Spot face 14 dia. Depth 9.6	8.7	M10 Depth 15	58	67	21	2	4 ^{+0.07} _{-0.02} depth 4.5	59	78h9	M5	55	18	37	14.5	20.5	37	22	13	111	155	5.6	57	68	32H9	2	13H9	7.5	2.9	26H9	2.5	10
50	M8 Depth 13	50	M8 Depth 12	60	88	Spot face 17.5 dia. Depth 10.8	10.5	M12 Depth 18	66	74	24	2	5 ^{+0.07} _{-0.02} depth 5.5	69	92h9	Rc1/8	71	23	48	21.5	27.5	36	32.5	17.5	129	177	8.1	58	75	37H9	4	14H9	10.5	5.3	28H9	4.5	15
80	M8 Depth 13	54	M8 Depth 12	66	94	Spot face 17.5 dia. Depth 10.8	10.5	M12 Depth 18	69	80	26	2	5 ^{+0.07} _{-0.02} depth 5.5	76	101h9	Rc1/8	80	25	55	24	30	40	35	19	135	183	8.1	58	80	40H9	3	17H9	9.5	4.4	36H9	3.5	15

Size	SA		SB	TA	TB	TC	UA	UB	V	W	X	LD		RD	
	90°	180°										90°	180°		
5	73	90	14	6.5	M6 X 1	8.7	16.6	16	3	10	12.6	21.5	25.5	22.5	25.5
10	83	107	15	4.9	M8 X 0.75	4.9	17.1	19.4	4	11	13.1	24.5	30.5	26	30.5
20	96	125	17	6.1	M10 X 1	5.7	17.6	24	5	13	13.6	31	37.5	31	37.5
30	121	165	25	6.1	M10 X 1	3.8	17.6	34	5	13	13.6	38.5	49.5	40	49.5
50	144	192	29.5	7	M12 X 1	3.5	24.6	35	6	14	20.6	48.5	61	51	61
80	150	198	29.5	7	M12 X 1	3.5	27.1	36	6	14	23.1	51.5	64	54	64

- RRC
- GRC
- RV / RV2
- NHS
- HR
- LN
- FH100
- HAP
- BSA2
- BHA / BHG
- HKP
- HLA / HLB
- HLAG / HLBG
- HEP
- HCP
- HMF
- HMFB
- HFP
- HLC
- HGP
- FH500
- HBL
- HDL
- HJL
- BHE
- CKG
- CK
- CKA
- CKF
- CKJ
- CKL2
- CKL2 -HC
- CKH2
- CKLB2
- CU
- NCK / SCK / FCK
- FJ
- FK
- ABP
- Oscillators / rotary actuators
- Table type rotary actuator

Dimensions: With outer mount shock absorber Torque5

• GRC-5-⁻A1/A2

 (File name: Page 55 or Ending 153 to 154)

Note: Figure shows A1 type (installation position (1)).

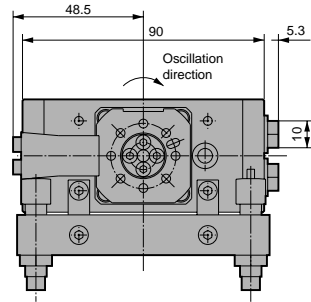
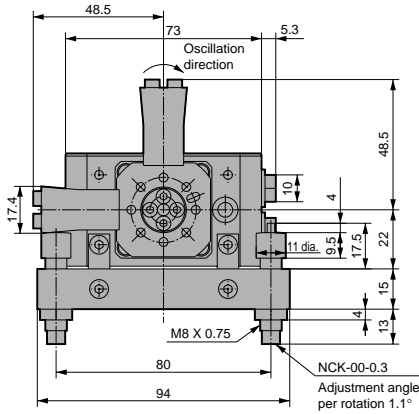

180° specifications

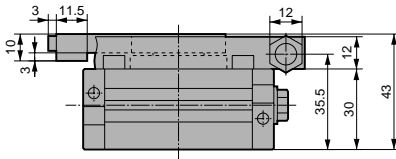

90° specifications

Note: Dimensions of rotary actuator main body are as same as basic type, however the body can not be fixed with using 4 taps on main body top. Position for dowel hole differs depending on installation position of outer mount shock absorber on table top.

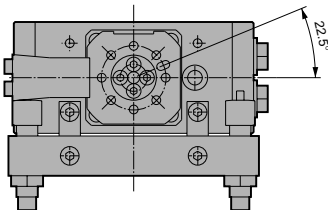

GRC-5-⁻A1

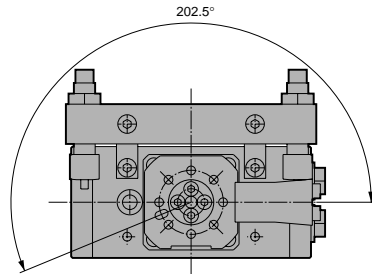

GRC-5-⁻A2

Dimensions: Torque 10, 20 with outer mount shock absorber

• GRC-10-*-A1/A2

 (File name: Page 55 or Ending 153 to 154)

Note: Figure shows A1 type (installation position (1)).

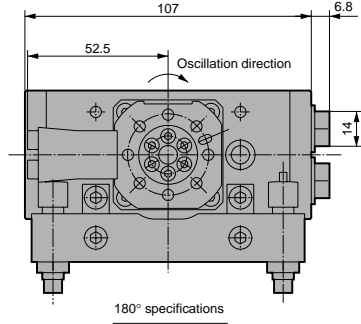
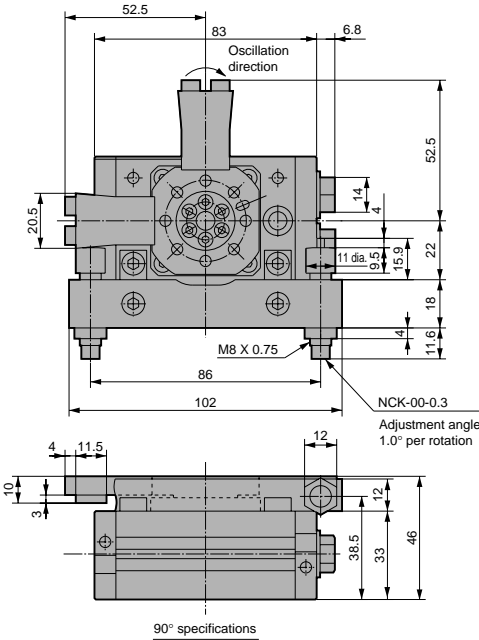

Note: Dimensions of rotary actuator main body are as same as basic type, however the body can not be fixed with using 4 taps on main body top. Position for dowel hole differs depending on installation position of outer mount shock absorber on table top.
(Refer to GRC-5-*-A1/A2.)

• GRC-20-*-A1/A2

 (File name: Page 55 or Ending 153 to 154)

Note: Figure shows A1 type (installation position (1)).

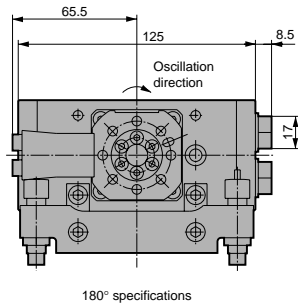
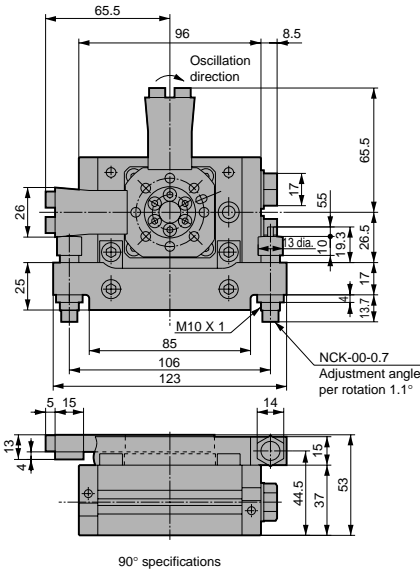

Note: Dimensions of rotary actuator main body are as same as basic type, however the body can not be fixed with using 4 taps on main body top. Position for dowel hole differs depending on installation position of outer mount shock absorber on table top.
(Refer to GRC-5-*-A1/A2.)

RRC
GRC
RV / RV2
NHS
HR
LN
FH100
HAP
BSA2
BHA / BHG
HKP
HLA / HLB
HLAG / HLBG
HEP
HCP
HMFB
HFP
HLC
HGP
FH500
HBL
HDL
HJL
BHE
CKG
CK
CKA
CKF
CKJ
CKL2
CKL2 -HC
CKH2
CKLB2
CU
NCK / SCK / FCK
FJ
FK
ABP

Oscillators / rotary actuators
Table type rotary actuator

Dimensions: Torque 30, 50 with outer mount shock absorber

• GRC-30-*-A1/A2

 (File name: Page 55 or Ending 153 to 154)

Note: Figure shows A1 type (installation position (1)).

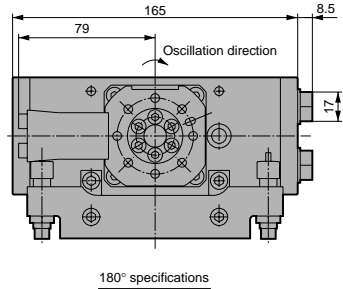
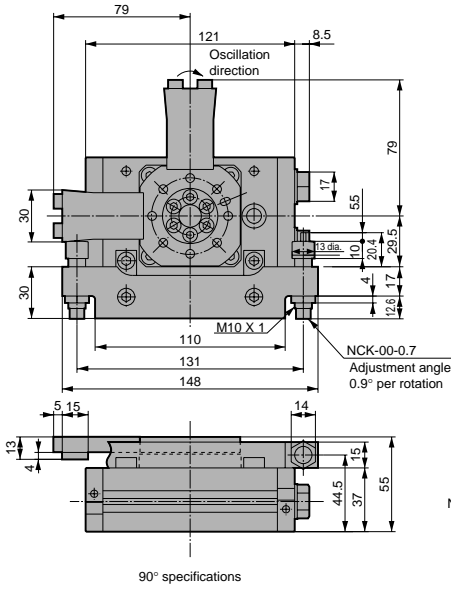

Note: Dimensions of rotary actuator main body are as same as basic type, however can not be fixed with using 4 taps on main body top. Position for dowel hole differs depending on installation position of outer mount shock absorber on table top.
(Refer to GRC-5-*-A1/A2.)

• GRC-50-*-A1/A2

 (File name: Page 55 or Ending 153 to 154)

Note: Figure shows A1 type (installation position (1)).

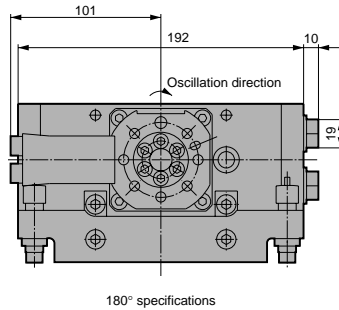
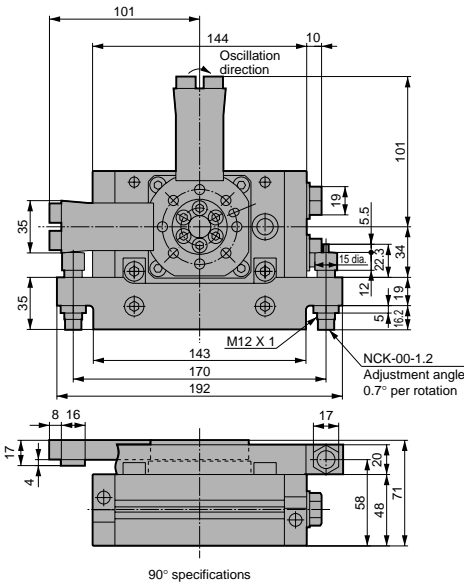

Note: Dimensions of rotary actuator main body are as same as basic type, however can not be fixed with using 4 taps on main body top. Position for dowel hole differs depending on installation position of outer mount shock absorber on table top.
(Refer to GRC-5-*-A1/A2.)

Dimensions: Torque 80 with outer mount shock absorber

• GRC-80-*-A1/A2

 (File name: Page 55 or Ending 153 to 154)

Note: Figure shows A1 type (installation position (1)).

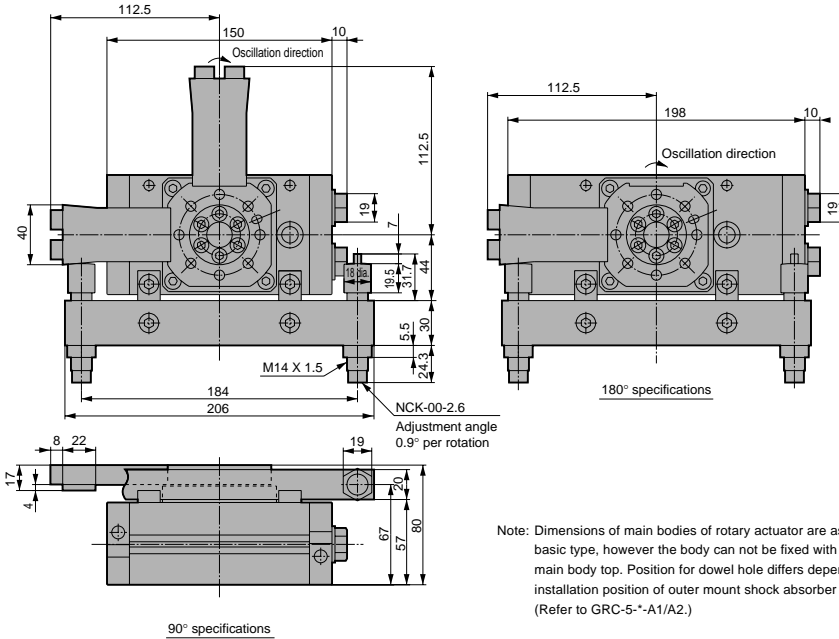

Note: Dimensions of main bodies of rotary actuator are as same as basic type, however the body can not be fixed with using 4 taps on main body top. Position for dowel hole differs depending on installation position of outer mount shock absorber on table top. (Refer to GRC-5-*-A1/A2.)

RRC
GRC
RV * / RV2 *
NHS
HR
LN
FH100
HAP
BSA2
BHA / BHG
HKP
HLA / HLB
HLAG / HLBG
HEP
HCP
HMFB
HFP
HLC
HGP
FH500
HLB
HDL
HJL
BHE
CKG
CK
CKA
CKF
CKJ
CKL2
CKL2 -HC
CKH2
CKLB2
CU
NCK / SCK / FCK
FJ
FK
ABP

Oscillators / rotary actuators
Table type rotary actuator

Dimensions: Outer mount shock absorber torque 5 to 80 for later installation

• GRC-A-A3  (File name: Page 55 or Ending 153 to 154)

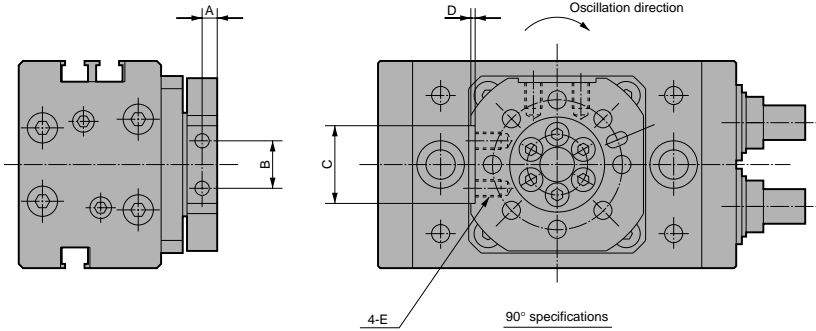

Torque	A	B	C	D	E
5	3.5	8.4	15 ^{+0.3} ₀	1	M3 Depth 6.5
10	3.5	11	18 ^{+0.3} ₀	1	M4 Depth 6
20	4.5	13.4	23 ^{+0.3} ₀	1	M5 Depth 7.5
30	4.5	17	27 ^{+0.3} ₀	2	M5 Depth 8.5
50	6.5	18.4	32 ^{+0.3} ₀	2	M8 Depth 9
80	6.5	20	36 ^{+0.3} ₀	2	M8 Depth 9

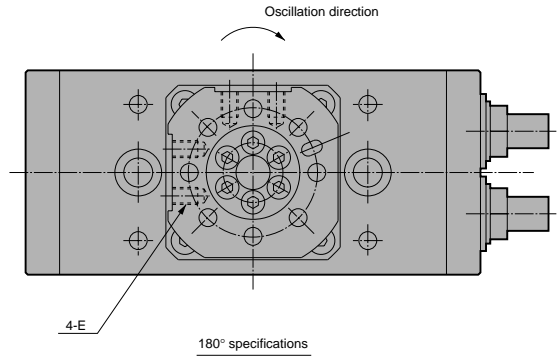

When outer mount shock absorber set is installed. ( shaded section shows outer mount shock absorber set.)

Note: When outer mount shock absorber set is installed on A3 type, A1 type is provided.

If A2 type, consult with CKD (refer to Page 34 for installation position.)

