

Dimensions

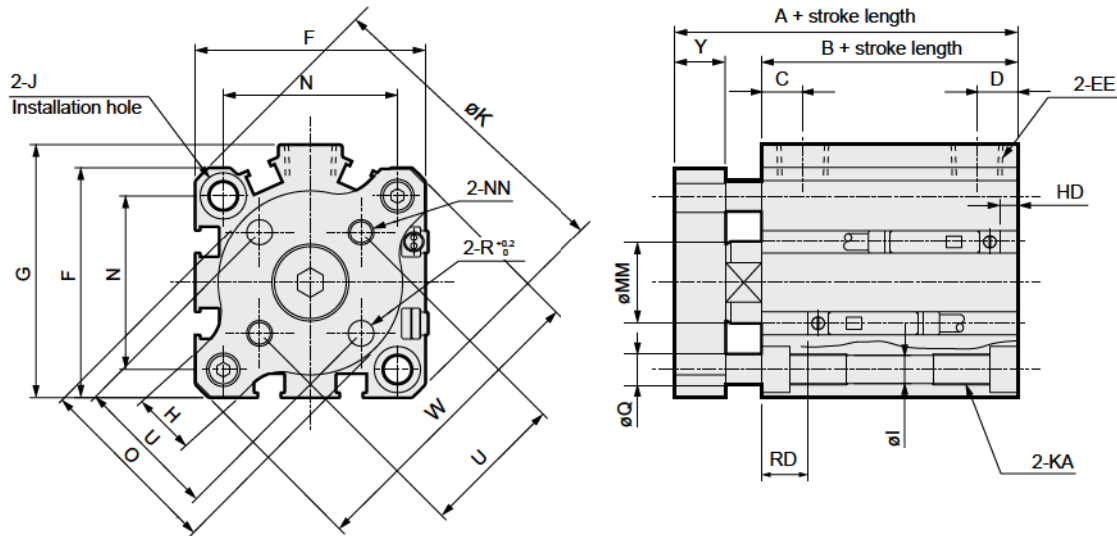

● Notes on switch installation groove

Note 1: Tube bore size $\phi 12$ to 20 does not have a switch groove on the piping port face.

Note 2: For tube bore size $\phi 12$ and 16 switch grooves, only one row is provided on each face.

Note 3: Only F type switch is installable on the tube bore size $\phi 25$ piping port face.

Symbol	Without switch		With switch		Common dimension												
Bore size	A Note 5	B Note 5	A Note 6	B Note 6	C Note 4	D Note 4	EE	F	G	H	I	J	K	KA	MM	N	NN
$\phi 12$	26.5	17	31.5 (36.5)	22 (27)	5.5	5.5	M5	25	-	8.5	3.5	6.5 spot face depth 3.5	32	M4 depth 7	6	15.5	M3
$\phi 16$	26.5	17	31.5 (36.5)	22 (27)	5.5	5.5	M5	29	-	9	3.5	6.5 spot face depth 3.5	38	M4 depth 7	8	20	M3
$\phi 20$	32	19.5	42	29.5	8	5.5	M5	36	-	10	5.5	9 spot face depth 5.5	47	M6 depth 11	10	25.5	M4
$\phi 25$	35.5	22.5	45.5	32.5	11	6	M5	40	-	11	5.5	9 spot face depth 5.5	51	M6 depth 11	12	28	M5
$\phi 32$	40 (50)	23 (33)	50	33	8 (10)	8 (5.5)	Rc1/8 Note 3	45	49.5	12	5.5	9 spot face depth 5.5	60	M6 depth 11	16	34	M5
$\phi 40$	46.5 (56.5)	29.5 (39.5)	56.5	39.5	12 (11.5)	8.5 (8)	Rc1/8	52	57	12	5.5	9 spot face depth 5.5	69	M6 depth 11	16	40	M5
$\phi 50$	50.5 (60.5)	30.5 (40.5)	60.5	40.5	10.5	10.5	Rc1/4	64	71	15	6.9	11 spot face depth 6.5	86	M8 depth 13	20	50	M6
$\phi 63$	56 (66)	36 (46)	66	46	13	11	Rc1/4	77	84	18	8.7	14 spot face depth 9	103	M10 depth 25	20	60	M6
$\phi 80$	67.5 (77.5)	43.5 (53.5)	77.5	53.5	16	13	Rc3/8	98	104	22	10.5	17.5 spot face depth 11	132	M12 depth 28	25	77	M8
$\phi 100$	79 (89)	53 (63)	89	63	23	15	Rc3/8	117	123.5	22	10.5	17.5 spot face depth 11	156	M12 depth 28	30	94	M10
Symbol	Common dimension						With switch (reed and proximity 1 color)		With switch (proximity 2 color)		With switch (T8)		With switch (T2/3W)				
Bore size	O	Q	R	U	Y	W	HD Note 5, Note 7	RD Note 5, Note 7	HD Note 5, Note 7	RD Note 5, Note 7	HD Note 5	RD Note 5	HD Note 5	RD Note 5			
$\phi 12$	15	5	3	10 ±0.1	6	31	0	2.5	4.5	1	-	-	7.5	4			
$\phi 16$	19	5	3	14 ±0.1	6	37	0	2	4.5	0.5	-	-	7.5	3.5			
$\phi 20$	26	6	4	17 ±0.1	8	46	3	6.5	1.5	5	-	-	4.5	8			
$\phi 25$	30	6	5	22 ±0.1	8	50	3 (8.5)	9.5 (14)	1.5 (8.5)	8 (14)	-	-	4.5	11			
$\phi 32$	36	6	5	28 ±0.2	10	59	3.5 (2)	9 (10.5)	2 (0.5)	7.5 (9)	-	-	5 (3.5)	10.5 (13)			
$\phi 40$	42	6	5	33 ±0.2	10	68	7 (4.5)	12 (14.5)	5.5 (3)	10.5 (13)	1 (0)	6 (8.5)	8.5 (6)	13.5 (16)			
$\phi 50$	54	8	6	42 ±0.2	12	85	7.5 (10.5)	12.5 (9.5)	6 (9)	11 (8)	1.5 (4.5)	6.5 (3.5)	9 (12)	14 (11)			
$\phi 63$	68	12	6	50 ±0.2	12	102	12.5 (15.5)	13 (10)	11 (14)	11.5 (8.5)	6.5 (9.5)	7 (4)	14 (17)	14.5 (11.5)			
$\phi 80$	88	14	8	65 ±0.2	14	131	17.5 (21)	15.5 (12)	16 (19.5)	14 (10.5)	11.5 (15)	9.5 (6)	19 (22.5)	17 (13.5)			
$\phi 100$	106	14	10	80 ±0.2	16	155	23 (26.5)	19.5 (16)	21.5 (25)	18 (14.5)	17 (20.5)	13.5 (10)	24.5 (28)	21 (17.5)			

Note 1: When calculating A + and B + stroke dimensions for the intermediate stroke, do not set the intermediate stroke in the stroke. Instead, set the next larger standard stroke. Example: If the intermediate stroke is 7 mm, calculate including standard stroke 10 mm.

Note 2: HD and RD dimensions for the 5 stroke will differ from these due to manufacturing.

Note 3: The port size is M5 for the $\phi 32$ 5 stroke with no switch.

Note 4: Dimensions in () of C and D columns are values for the 5 stroke with no switch.

Note 5: Dimensions in () of A, B, HD, and RD columns are values for 75 and 100 strokes.

Note 6: Dimensions in () of A and B columns are values for 2-color indicator and preventive maintenance output with switch (L1).

Note 7: Dimensions