

Dimensions

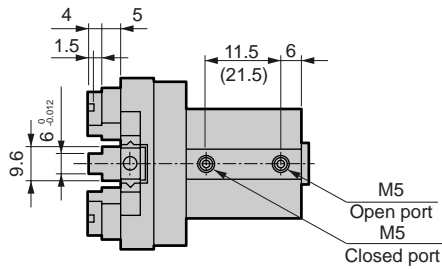

● CKG-16CS standard/O/C

· Dimensions in () for O [normally open] and C [normally closed] specifications.



● With switch

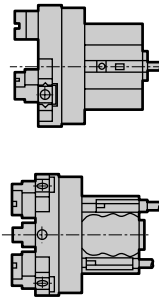

● With rubber cover

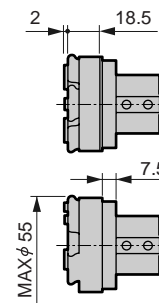
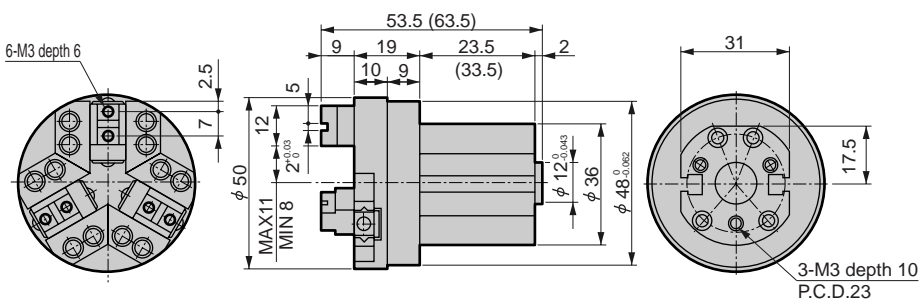

● CKG-25CS standard/O/C

· Dimensions in () for O [normally open] and C [normally closed] specifications.

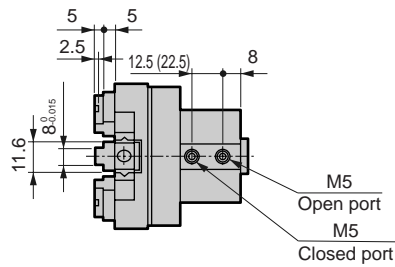

● With switch

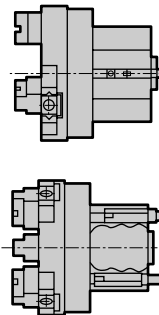

● With rubber cover

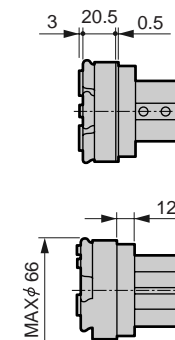
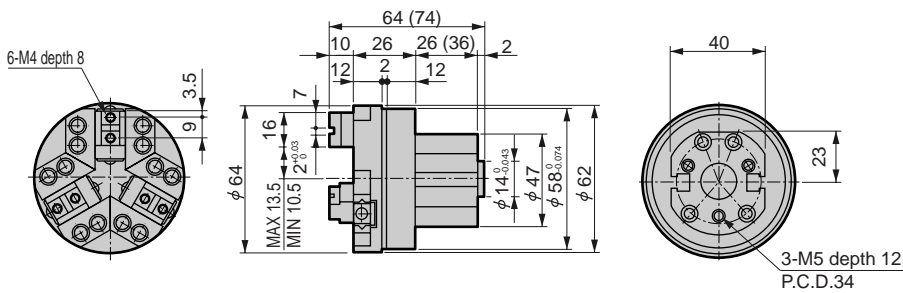

RRC
GRC
RV3*
NHS
HR
LN
FH100
HAP
BSA2
BHA/BHG
LHA
LHAG
HKP
HLA/HLB
HLAG/HLBG
HEP
HCP
HMF
HMFB
HFP
HLC
HGP
FH500
HBL
HDL
HMD
HJL
BHE
CKG
CK
CKA
CKS
CKF
CKJ
CKL2
CKL2 *-HC
CKH2
CKLB2
NCK/SCK/FCK
FJ
FK
Ending

3-way jaw bearing chuck
Chuck

Dimensions



RRC
GRC
RV3*
NHS
HR
LN
FH100
HAP
BSA2
BHA/ BHG
LHA
LHAG
HKP
HLA/ HLB
HLAG/ HLBG
HEP
HCP
HMF
HMFB
HFP
HLC
HGP
FH500
HBL
HDL
HMD
HJL
BHE
CKG
CK
CKA
CKS
CKF
CKJ
CKL2
CKL2 -*.HC
CKH2
CKLB2
NCK/ SCK/FCK
FJ
FK
Ending

● CKG-32CS standard/O/C

· Dimensions in () for O [normally open] and C [normally closed] specifications.

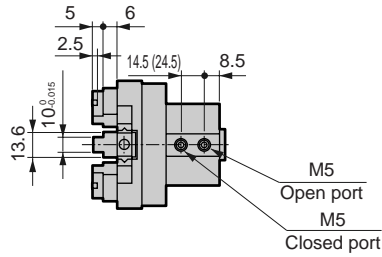

● With switch

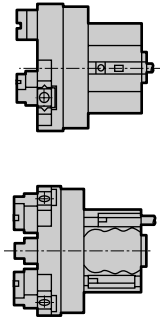

6-M4 depth 8

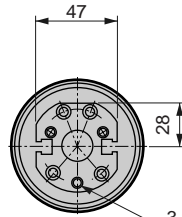
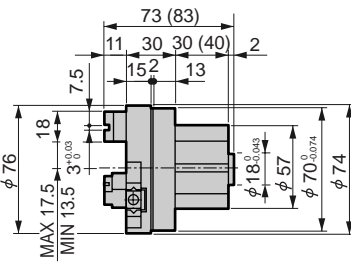
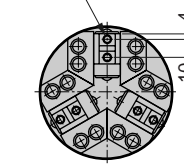

● With rubber cover

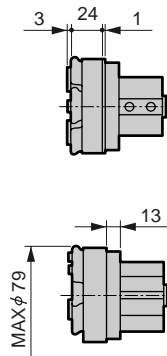

● CKG-40CS standard/O/C

· Dimensions in () for O [normally open] and C [normally closed] specifications.

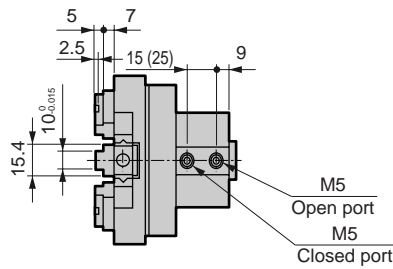

● With switch

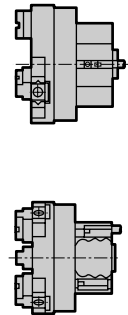

6-M5 depth 8

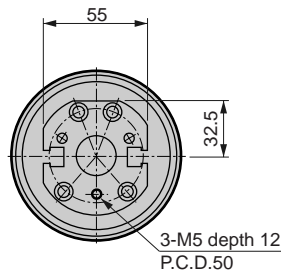
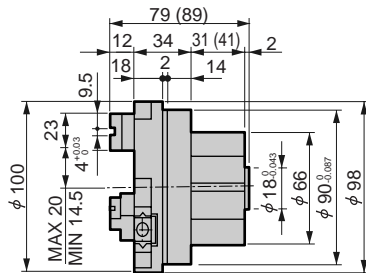
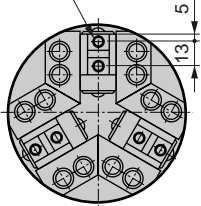

● With rubber cover

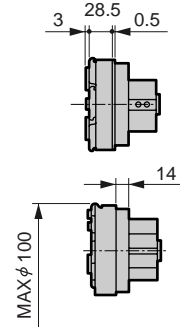

Dimensions



● CKG-50CS standard/O/C

· Dimensions in () for O [normally open] and C [normally closed] specifications.

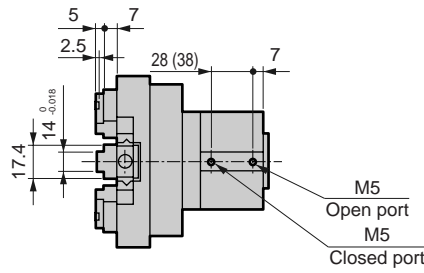

● With switch

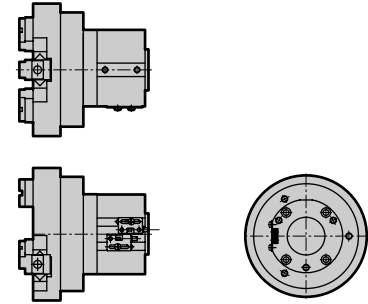

● With rubber cover

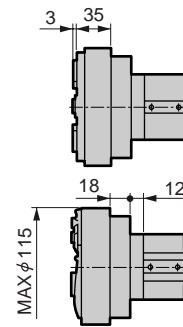

6-M6 depth 10

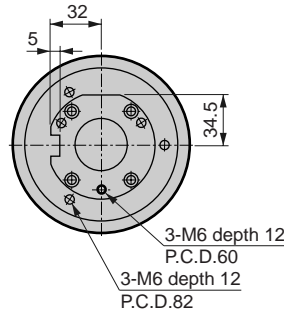
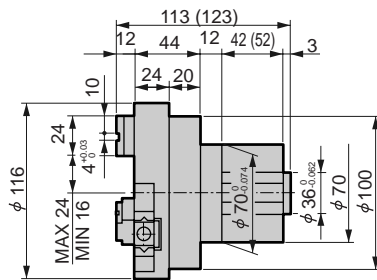
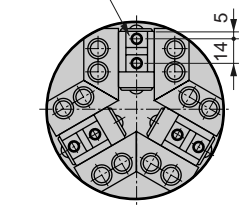

RRC
GRC
RV3*
NHS
HR
LN
FH100
HAP
BSA2
BHA/BHG
LHA
LHAG
HKP
HLA/HLB
HLAG/HLBG
HEP
HCP
HMF
HMFB
HFP
HLC
HGP
FH500
HLB
HDL
HMD
HJL
BHE
CKG
CK
CKA
CKS
CKF
CKJ
CKL2
CKL2 *-HC
CKH2
CKLB2
NCK/SCK/FCK
FJ
FK
Ending

3-way jaw bearing chuck
Chuck