

Floor Standing Enclosures
Aluminium Range | Aluminium
Single wall, compact | EKOM-SW

IP 66 | TYPE 4X, 12, 13 | IK 10



01

Floor Standing Enclosures

1

Material:

Aluminium AlMg3. Frame: 2 mm. Door: 2 mm. Rear panel: 2 mm. Rain hood: 2 mm.

Body:

One piece enclosure body. Integrated depth profiles with hole pattern allowing mounting plate adjustable in depth. The frame in multiple door versions, is divided into individual modules by means of vertical dividers.

Door:

Double walled with top and bottom ventilation openings allowing air flow. Mounted with concealed hinges allowing left or right hand opening. Multiple door version has individual lockable doors.

Rear panel:

Fastened from the inside. Standard facilities for rear door mounting.

Rainhood:

Sloped rainhood with integrated rain gutter and ventilation channels in the perimeter.

Lock:

Espagnolette multiple point locking system. Standard swing handle with security lock.

Bottom plates:

Supplied as accessory.

Earthing:

All panels are earthed through their fittings and are equipped with a separate earthing stud.

Finish:

RAL 7035 structure powder coating 100% polyester.

Protection:

Corresponds with IP 66 | TYPE 4X, 12, 13 | IK 10, when a bottom plate is fitted.

Approvals:

CE, EAC, GOST, cULus_listed. Climatic and Chemically active substances resistance according to EN61969-3 "Mechanical structures for electronic equipment. Outdoor enclosures".

Delivery:

Frame with fitted door with swinghandle, rear panel, rain hood. Delivery also includes earthing bolts. Delivered on a pallet which is identical to the width of the enclosure to allow suiting without removal. All packing material is recyclable. Mounting plate and bottom plates are not included in the standard delivery.



Dimensional table | EKOM-SW

IP 66 | TYPE 4X, 12, 13 | IK 10

Without Mounting plate/Bottom plate

Enclosure dimensions			N° of doors	Item no.
H	W	D		
1200	600	400	1	EKOM12064-SW
1200	600	600	1	EKOM12066-SW
1200	800	400	1	EKOM12084-SW
1200	800	600	1	EKOM12086-SW
1200	1200	400	2	EKOM12124-SW
1400	1800	400	3	EKOM14184-SW



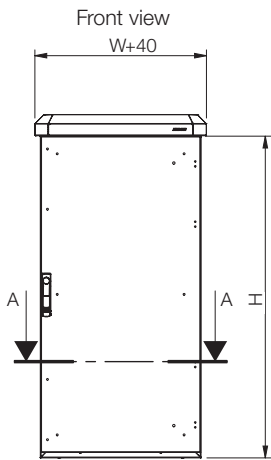

Front view

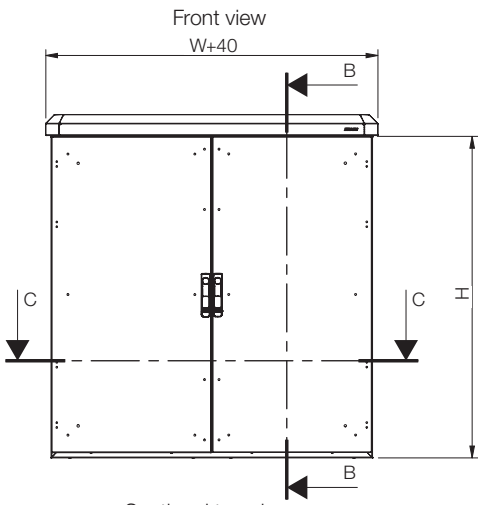

Front view

Sectional side view

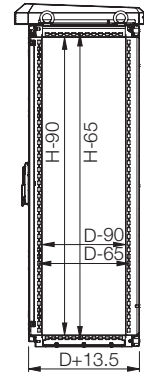

SECTION B-B

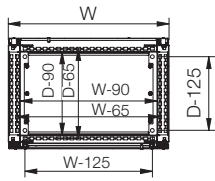

SECTION A-A

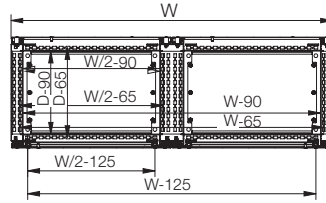

SECTION C-C

Bottom view

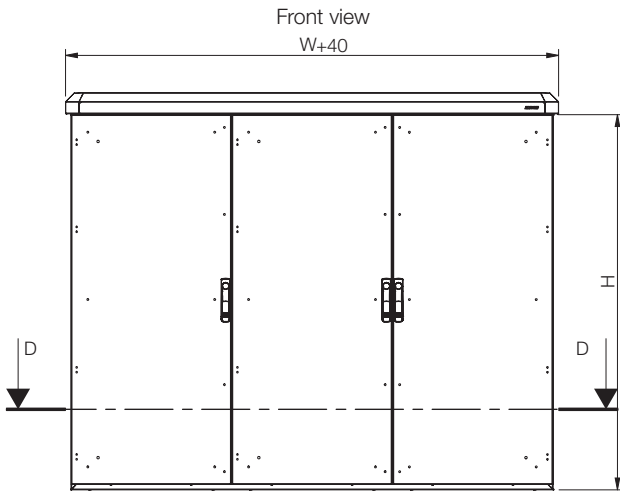
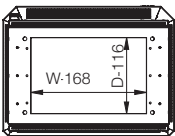

Front view

Side view

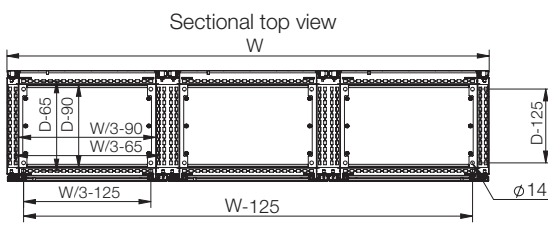
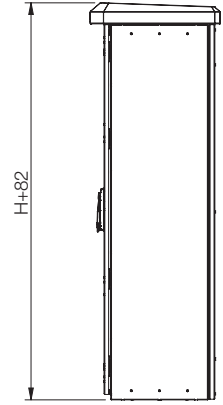

SECTION D-D

Rainhood side view

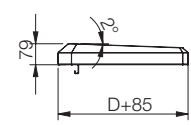

Accessories selection matrix | EKOM-SW



Enclosure				Mounting							
H	W	D	Mounting plate	Aluminium mounting plate	Mounting profile, in H	Mounting profile, in W	Mounting profile, in D	Click in profile, in W	Click in profile, in D		
EKOM12064-SW	1200	600	400	MP1206	MPAL1206	CLPF1200	CLPF600	CLPF400	CLPK600	CLPK400	
EKOM12066-SW	1200	600	600	MP1206	MPAL1206	CLPF1200	CLPF600	CLPF600	CLPK600	CLPK600	
EKOM12084-SW	1200	800	400	MP1208	MPAL1208	CLPF1200	CLPF800	CLPF400	CLPK800	CLPK400	
EKOM12086-SW	1200	800	600	MP1208	MPAL1208	CLPF1200	CLPF600	CLPF600	CLPK600	CLPK600	
EKOM12124-SW	1200	1200	400	2x MP1206	2x MPAL1206	CLPF1200	2x CLPF600	CLPF400	2x CLPK600	CLPK400	
EKOM14184-SW	1400	1800	400	3x MP1206	3x MPAL1206	CLPF1400	3x CLPF600	CLPF400	3x CLPK600	CLPK400	

Enclosure				Mounting				Fixing	Cable
H	W	D	Mounting profiles (19") *	Brackets for fixing 19" mounting profiles	Carrier bars, in D	Carrier bars, in W	Plinth (100 mm height)	Aluminium bottom plates	
EKOM12064-SW	1200	600	400	CIP24	CIB600	CB400	CB600	PFAL1064	CBPA064
EKOM12066-SW	1200	600	600	CIP24	CIB600	CB600	CB600	PFAL1066	CBPA066
EKOM12084-SW	1200	800	400	CIP24	CIB800	CB400	CB800	PFAL1084	CBPA084
EKOM12086-SW	1200	800	600	CIP24	CIB800	CB600	CB800	PFAL1086	CBPA086
EKOM12124-SW	1200	1200	400	CIP24	CIB600	CB400	CB600	PFAL1124	2x CBPA064
EKOM14184-SW	1400	1800	400	CIP29	CIB600	CB400	CB600	PFAL1184	3x CBPA064

* CIB, CID or CIWR are required.