

Końcówka złącza z gwintem walcowym

Fitting with parallel thread

CD16

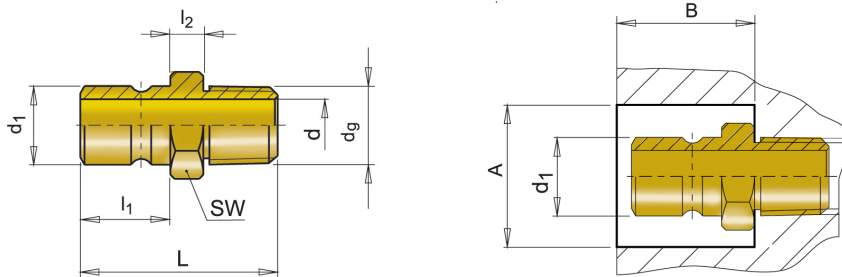

NR KAT.	dg	d	d1	l1	l2	SW	L	A	B
CD16-9-10	M10x1	6	9	10,5	4,5	11	24	21	20
CD16-9-14	M14x1,5						25	24	
CD16-13-10	M10x1								
CD16-13-12	M12x1,25	9	13	15,5	5,5	14	30	27	26
CD16-13-14	M14x1,5								
CD16-13-1/4	G 1/4"								
CD16-13-3/8	G 3/8"	15	20	19,5	6	22	39	34	30
CD16-20-3/8	G 3/8"								
CD16-20-1/2	G 1/2"								