

**Kotek walcowy**

Dowel pin

**KW**

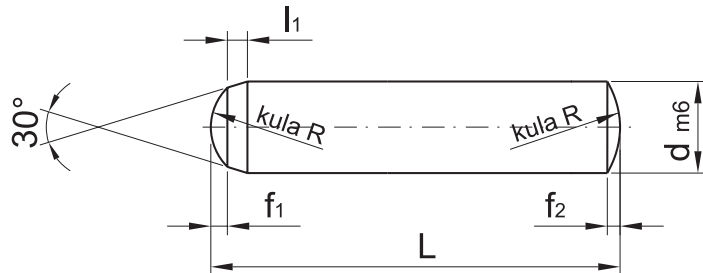

Hartowany  
Hardened **60±2 HRC**

| d   | f1   | f2   | l1  | R   | L  | NR KAT.   |
|-----|------|------|-----|-----|----|-----------|
| 1   | 0,08 | 0,15 | 0,4 | 1   | 8  | KW-010008 |
|     |      |      |     |     | 10 | KW-010010 |
|     |      |      |     |     | 12 | KW-010012 |
| 1,5 | 0,12 | 0,23 | 0,5 | 1,6 | 8  | KW-015008 |
|     |      |      |     |     | 10 | KW-015010 |
|     |      |      |     |     | 12 | KW-015012 |
|     |      |      |     |     | 14 | KW-015014 |
|     |      |      |     |     | 16 | KW-015016 |
| 2   | 0,18 | 0,3  | 0,6 | 2   | 6  | KW-020006 |
|     |      |      |     |     | 8  | KW-020008 |
|     |      |      |     |     | 10 | KW-020010 |
|     |      |      |     |     | 12 | KW-020012 |
|     |      |      |     |     | 14 | KW-020014 |
|     |      |      |     |     | 16 | KW-020016 |
|     |      |      |     |     | 18 | KW-020018 |
|     |      |      |     |     | 20 | KW-020020 |
|     |      |      |     |     | 24 | KW-020024 |
| 2,5 | 0,25 | 0,4  | 0,7 | 2,5 | 6  | KW-025006 |
|     |      |      |     |     | 8  | KW-025008 |
|     |      |      |     |     | 10 | KW-025010 |
|     |      |      |     |     | 12 | KW-025012 |
|     |      |      |     |     | 14 | KW-025014 |
|     |      |      |     |     | 16 | KW-025016 |
|     |      |      |     |     | 18 | KW-025018 |
|     |      |      |     |     | 20 | KW-025020 |
|     |      |      |     |     | 24 | KW-025024 |

| d | f1  | f2   | l1  | R | L  | NR KAT.   |
|---|-----|------|-----|---|----|-----------|
| 3 | 0,3 | 0,45 | 0,8 | 3 | 6  | KW-030006 |
|   |     |      |     |   | 8  | KW-030008 |
|   |     |      |     |   | 10 | KW-030010 |
|   |     |      |     |   | 12 | KW-030012 |
|   |     |      |     |   | 14 | KW-030014 |
|   |     |      |     |   | 16 | KW-030016 |
|   |     |      |     |   | 18 | KW-030018 |
|   |     |      |     |   | 20 | KW-030020 |
|   |     |      |     |   | 24 | KW-030024 |
|   |     |      |     |   | 28 | KW-030028 |
| 4 | 0,4 | 0,6  | 1   | 4 | 32 | KW-030032 |
|   |     |      |     |   | 36 | KW-030036 |
|   |     |      |     |   | 40 | KW-030040 |
|   |     |      |     |   | 45 | KW-030045 |
|   |     |      |     |   | 6  | KW-040006 |
|   |     |      |     |   | 8  | KW-040008 |
|   |     |      |     |   | 10 | KW-040010 |
|   |     |      |     |   | 12 | KW-040012 |
|   |     |      |     |   | 14 | KW-040014 |
|   |     |      |     |   | 16 | KW-040016 |
|   |     |      |     |   | 18 | KW-040018 |
|   |     |      |     |   | 20 | KW-040020 |
|   |     |      |     |   | 24 | KW-040024 |
|   |     |      |     |   | 28 | KW-040028 |
| 5 | 0,5 | 0,75 | 1,2 | 5 | 32 | KW-040032 |
|   |     |      |     |   | 36 | KW-040036 |
|   |     |      |     |   | 40 | KW-040040 |
|   |     |      |     |   | 45 | KW-040045 |
|   |     |      |     |   | 50 | KW-040050 |
|   |     |      |     |   | 55 | KW-040055 |
| 5 | 0,5 | 0,75 | 1,2 | 5 | 60 | KW-040060 |
|   |     |      |     |   | 8  | KW-050008 |
|   |     |      |     |   | 10 | KW-050010 |

**Uwaga: Inne wymiary i tolerancje na specjalne zamówienie.**

Note: Other dimensions and tolerances on request only.

Zastrzegamy sobie prawo do zmian bez uprzedzenia. Zawsze sprawdzaj aktualność katalogu na stronie [www.proplastica.pl](http://www.proplastica.pl)  
We reserve the right to amend this catalogue without notice. Always check [www.proplastica.pl](http://www.proplastica.pl) for latest updates.

**Kołek walcowy**

Dowel pin

**KW**

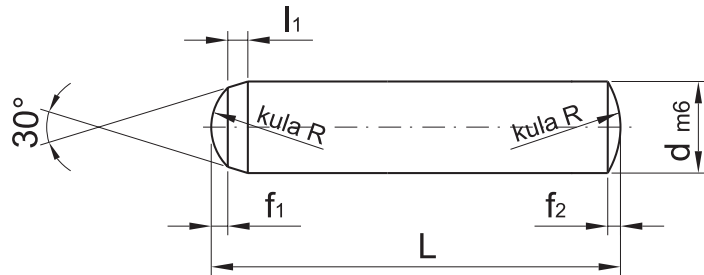

Hartowany  
Hardened 60±2 HRC

| d  | f1        | f2   | l1  | R | L  | NR KAT.   |
|----|-----------|------|-----|---|----|-----------|
| 5  | 0,5       | 0,75 | 1,2 | 5 | 12 | KW-050012 |
|    |           |      |     |   | 14 | KW-050014 |
|    |           |      |     |   | 16 | KW-050016 |
|    |           |      |     |   | 18 | KW-050018 |
|    |           |      |     |   | 20 | KW-050020 |
|    |           |      |     |   | 24 | KW-050024 |
|    |           |      |     |   | 28 | KW-050028 |
|    |           |      |     |   | 32 | KW-050032 |
|    |           |      |     |   | 36 | KW-050036 |
|    |           |      |     |   | 40 | KW-050040 |
|    |           |      |     |   | 45 | KW-050045 |
|    |           |      |     |   | 50 | KW-050050 |
|    |           |      |     |   | 55 | KW-050055 |
|    |           |      |     |   | 60 | KW-050060 |
| 6  | 0,6       | 0,9  | 1,5 | 6 | 8  | KW-060008 |
|    |           |      |     |   | 10 | KW-060010 |
|    |           |      |     |   | 12 | KW-060012 |
|    |           |      |     |   | 14 | KW-060014 |
|    |           |      |     |   | 16 | KW-060016 |
|    |           |      |     |   | 18 | KW-060018 |
|    |           |      |     |   | 20 | KW-060020 |
|    |           |      |     |   | 24 | KW-060024 |
|    |           |      |     |   | 28 | KW-060028 |
|    |           |      |     |   | 32 | KW-060032 |
|    |           |      |     |   | 36 | KW-060036 |
|    |           |      |     |   | 40 | KW-060040 |
|    |           |      |     |   | 45 | KW-060045 |
|    |           |      |     |   | 50 | KW-060050 |
| 55 | KW-060055 |      |     |   |    |           |
| 60 | KW-060060 |      |     |   |    |           |

| d  | f1        | f2  | l1  | R  | L   | NR KAT.   |
|----|-----------|-----|-----|----|-----|-----------|
| 8  | 0,8       | 1,2 | 1,8 | 8  | 10  | KW-080010 |
|    |           |     |     |    | 12  | KW-080012 |
|    |           |     |     |    | 14  | KW-080014 |
|    |           |     |     |    | 16  | KW-080016 |
|    |           |     |     |    | 18  | KW-080018 |
|    |           |     |     |    | 20  | KW-080020 |
|    |           |     |     |    | 24  | KW-080024 |
|    |           |     |     |    | 28  | KW-080028 |
|    |           |     |     |    | 32  | KW-080032 |
|    |           |     |     |    | 36  | KW-080036 |
|    |           |     |     |    | 40  | KW-080040 |
|    |           |     |     |    | 45  | KW-080045 |
|    |           |     |     |    | 50  | KW-080050 |
|    |           |     |     |    | 55  | KW-080055 |
| 10 | 1         | 1,5 | 2   | 10 | 60  | KW-080060 |
|    |           |     |     |    | 70  | KW-080070 |
|    |           |     |     |    | 80  | KW-080080 |
|    |           |     |     |    | 90  | KW-080090 |
|    |           |     |     |    | 100 | KW-080100 |
|    |           |     |     |    | 16  | KW-100016 |
|    |           |     |     |    | 18  | KW-100018 |
|    |           |     |     |    | 20  | KW-100020 |
|    |           |     |     |    | 24  | KW-100024 |
|    |           |     |     |    | 28  | KW-100028 |
|    |           |     |     |    | 32  | KW-100032 |
|    |           |     |     |    | 36  | KW-100036 |
|    |           |     |     |    | 40  | KW-100040 |
|    |           |     |     |    | 45  | KW-100045 |
| 50 | KW-100050 |     |     |    |     |           |
| 55 | KW-100055 |     |     |    |     |           |

Uwaga: Inne wymiary i tolerancje na specjalne zamówienie.

Note: Other dimensions and tolerances on request only.

Zastrzegamy sobie prawo do zmian bez uprzedzenia. Zawsze sprawdzaj aktualność katalogu na stronie www.proplastica.pl  
We reserve the right to amend this catalogue without notice. Always check www.proplastica.pl for latest updates.

**Kotek walcowy**

Dowel pin

**KW**

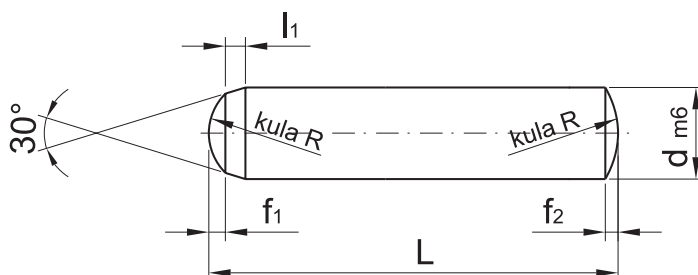

Hartowany  
Hardened **60±2 HRC**

| d   | f1        | f2  | l1  | R  | L   | NR KAT.   |
|-----|-----------|-----|-----|----|-----|-----------|
| 10  | 1         | 1,5 | 2   | 10 | 55  | KW-100060 |
|     |           |     |     |    | 70  | KW-100070 |
|     |           |     |     |    | 80  | KW-100080 |
|     |           |     |     |    | 90  | KW-100090 |
|     |           |     |     |    | 100 | KW-100100 |
|     |           |     |     |    | 120 | KW-100120 |
| 12  | 1,3       | 1,8 | 2,5 | 12 | 20  | KW-120020 |
|     |           |     |     |    | 24  | KW-120024 |
|     |           |     |     |    | 28  | KW-120028 |
|     |           |     |     |    | 32  | KW-120032 |
|     |           |     |     |    | 36  | KW-120036 |
|     |           |     |     |    | 40  | KW-120040 |
|     |           |     |     |    | 45  | KW-120045 |
|     |           |     |     |    | 50  | KW-120050 |
|     |           |     |     |    | 55  | KW-120055 |
|     |           |     |     |    | 60  | KW-120060 |
|     |           |     |     |    | 70  | KW-120070 |
|     |           |     |     |    | 80  | KW-120080 |
|     |           |     |     |    | 90  | KW-120090 |
|     |           |     |     |    | 100 | KW-120100 |
| 120 | KW-120120 |     |     |    |     |           |
| 14  | 1,3       | 2   | 2,5 | 16 | 36  | KW-140036 |
|     |           |     |     |    | 40  | KW-140040 |
|     |           |     |     |    | 45  | KW-140045 |
|     |           |     |     |    | 50  | KW-140050 |
|     |           |     |     |    | 55  | KW-140055 |

| d   | f1        | f2  | l1  | R  | L   | NR KAT.   |
|-----|-----------|-----|-----|----|-----|-----------|
| 14  | 1,3       | 2   | 2,5 | 16 | 60  | KW-140060 |
|     |           |     |     |    | 70  | KW-140070 |
|     |           |     |     |    | 80  | KW-140080 |
|     |           |     |     |    | 90  | KW-140090 |
|     |           |     |     |    | 100 | KW-140100 |
|     |           |     |     |    | 120 | KW-140120 |
| 16  | 1,7       | 2,5 | 3   | 16 | 40  | KW-160040 |
|     |           |     |     |    | 45  | KW-160045 |
|     |           |     |     |    | 50  | KW-160050 |
|     |           |     |     |    | 55  | KW-160055 |
|     |           |     |     |    | 60  | KW-160060 |
|     |           |     |     |    | 70  | KW-160070 |
|     |           |     |     |    | 80  | KW-160080 |
|     |           |     |     |    | 90  | KW-160090 |
|     |           |     |     |    | 100 | KW-160100 |
|     |           |     |     |    | 120 | KW-160120 |
| 20  | 2         | 3   | 4,0 | 20 | 140 | KW-160140 |
|     |           |     |     |    | 55  | KW-200055 |
|     |           |     |     |    | 60  | KW-200060 |
|     |           |     |     |    | 70  | KW-200070 |
|     |           |     |     |    | 80  | KW-200080 |
|     |           |     |     |    | 90  | KW-200090 |
|     |           |     |     |    | 100 | KW-200100 |
| 120 | KW-200120 |     |     |    |     |           |
| 140 | KW-200140 |     |     |    |     |           |

**Uwaga: Inne wymiary i tolerancje na specjalne zamówienie.**

Note: Other dimensions and tolerances on request only.