

GUIDE PILLAR WITH PILOT TAPPER, VDI 3356

2022.15.

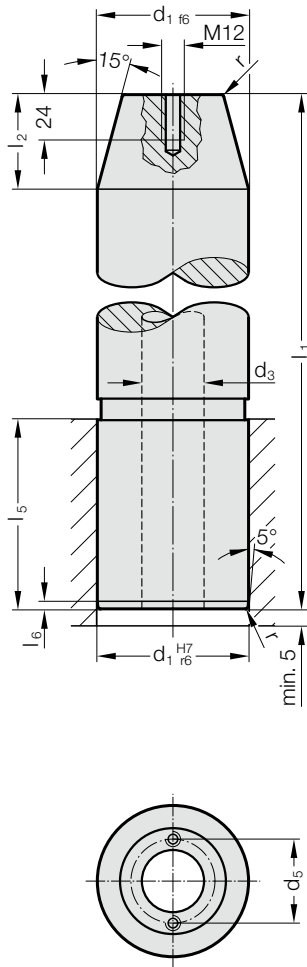

Material:

Steel, surface hardened

Surface hardness: 60 + 4 HRC, Hardness penetration 1,5 + 1 mm

Execution:

ground

ø d₁ = 80 without central hole with 1 lifting thread M12

from ø d₁ = 100 with central hole (through) and with 2 lifting threads M8

Note:

Guide pillar is recommended to be used only with guide elements with solid lubricant.

☞ Matching guide combinations, see selection matrix at the beginning of chapter D.

☞ Assembly guide lines / Dimensional requirements and tolerances at the end of chapter D.

2022.15. Guide pillar with pilot taper, VDI 3356

d ₁	80	100	125	160
d ₃	-	50	65	95
d ₅	-	62	82	119
r	3	3	4	4
l ₂	50	50	50	50
l ₅	100	125	140	180
l ₆	4	4	5	5
l ₁				
280	●			
315		●		
355	●	●	●	
400	●	●	●	
450	●	●	●	●
500			●	●
560				●

Ordering Code (example):

Guide pillar with pilot taper, VDI 3356	=	2022.15.
Diameter of conduit d ₁	125 mm =	125.
Length l ₁	355 mm =	355
Order No	=	2022.15. 125. 355