

# CLAMP, FORKED SHAPE, DIN 6315-B CLAMPING CLAW, GOOSE-NECK SHAPE

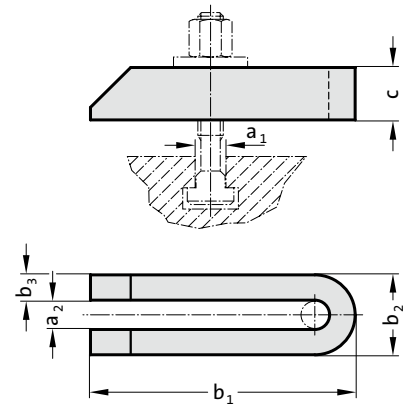

2140.17.



**Material:**

Heat-treated steel, painted

**Note:**

Holding and contact surfaces are plane-parallel. High clamping forces can be achieved by using high-strength screws conforming to DIN 787. The dimensions of the holding strap should be matched to the strength of the bolts.

Supplied without clamping bolt, suitable clamping bolts: 2140.30.

**2140.17. Clamp, forked shape, DIN 6315-B**

Order No	a <sub>1</sub>	a <sub>2</sub>	b <sub>1</sub>	b <sub>2</sub>	b <sub>3</sub>	c	
2140.17.09.080	8	9	80	25	8	15	
2140.17.11.100	10	11	100	31	10	20	
2140.17.14.125	12	14	14	125	38	12	25
2140.17.14.160	12	14	14	160	38	12	25
2140.17.14.200	12	14	14	200	38	12	25
2140.17.18.160	16	18	18	160	48	15	30
2140.17.18.200	16	18	18	200	48	15	30
2140.17.18.250	16	18	18	250	48	15	40
2140.17.22.200	20	22	22	200	52	15	40
2140.17.22.250	20	22	22	250	62	20	40
2140.17.22.315	20	22	22	315	62	20	40
2140.17.26.200	24	26	200	66	20	40	
2140.17.26.250	24	26	250	66	20	40	
2140.17.26.315	24	26	315	66	20	40	



2140.15.

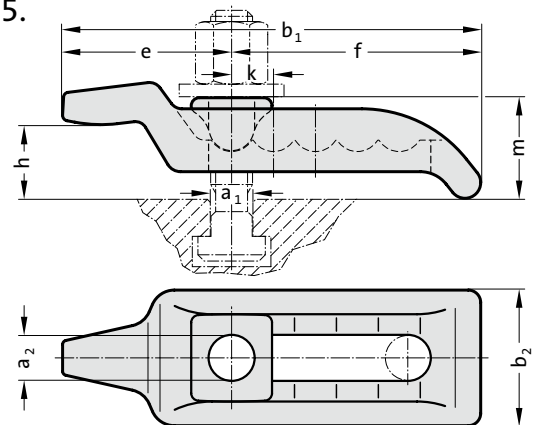

**Material:**

Steel, forged and heat-treated , galvanised and yellow passivated

**Note:**

Clamping claws quickly span very different clamping heights without the need for additional supports and take up very little space on the machine table. They are designed for maximum loads and are particularly suitable for clamping cutting and punching tools.

Supplied without clamping bolt, suitable clamping bolts: 2140.30.

**2140.15. Clamping claw, goose-neck shape**

Order No	a <sub>1</sub>	a <sub>2</sub>	b <sub>1</sub>	b <sub>2</sub>	e	f	k	m	Clamping height h	
2140.15.22	20	22	22	200	66	88	112	20	60	25 - 50
2140.15.26	24	26	26	232	76	97	135	24	70	30 - 70
2140.15.32	36	32	263	90	107	156	28	80	40 - 75	