

弹顶销, 表面渗氮, DIN 1530-1 A-TYP

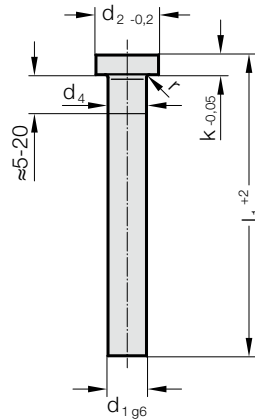

237.8.



材料:

NWA

订购编号 237.8.

硬度:

杆部* ≥ 950 HV 0,3

头部 45 ± 5 HRC

核抗张强度: > 1400 N/mm²

☞ 材料说明和其他材料见E章开头。

结构:

轴杆精密打磨, 经氮化处理。

头部顶锻并回火。

头部下方顶锻加粗

取消, 依据制造商操作程序。

d_4 : 对于 $d_1 < 5$ mm, $d_4 = d_1 + 0.03$

对于 $d_1 \geq 5$ mm, $d_4 = d_1 + 0.04$

对于 $d_1 \geq 18$ mm, $d_4 = d_1 + 0.07$

237.8. 弹顶销, 表面渗氮, DIN 1530-1 A-Typ

d_1	d_2	k	r	l_1	100	125	160	200	250	315	400	500	630	800
1.5	3	1.5	0.2		●	●	●	●						
2	4	2	0.2		●	●	●	●	●					
2.2	4	2	0.2		●	●	●	●						
2.4	5	2	0.2		●	●	●	●	●	●				
2.5	5	2	0.3		●	●	●	●	●	●				
2.7	5	2	0.3		●	●	●	●						
2.9	5	2	0.3		●	●	●	●	●	●				
3	6	3	0.3		●	●	●	●	●	●	●			
3.2	6	3	0.3		●	●	●	●	●	●	●	●		
3.4	6	3	0.3		●	●	●	●	●	●	●			
3.5	7	3	0.3		●	●	●	●	●	●	●			
3.7	7	3	0.3		●	●	●	●	●	●	●			
3.9	7	3	0.3		●	●	●	●	●	●	●			
4	8	3	0.3		●	●	●	●	●	●	●	●		
4.2	8	3	0.3		●	●	●	●	●	●	●	●		
4.4	8	3	0.3		●	●	●	●	●	●	●	●		
4.5	8	3	0.3		●	●	●	●	●	●	●	●		
4.7	8	3	0.3		●	●	●	●	●	●	●	●		
4.9	8	3	0.3		●	●	●	●	●	●	●	●		
5	10	3	0.3		●	●	●	●	●	●	●	●	●	
5.2	10	3	0.3		●	●	●	●	●	●	●	●	●	●
5.4	10	3	0.3		●	●	●	●	●	●	●	●	●	
5.5	10	3	0.3		●	●	●	●	●	●	●	●	●	
5.7	10	3	0.3		●	●	●	●	●	●	●	●	●	
5.9	10	3	0.3		●	●	●	●	●	●	●	●	●	

订购示例:

弹顶销, 表面渗氮, DIN 1530-1 A-Typ =237.8.

轴径 d_1 6.2 mm = 0620.

长度 l_1 100 mm = 100

订购编号 =237.8. 0620. 100

弹顶销, 表面渗氮, DIN 1530-1 A-TYP

材料:

NWA
 订购编号 237.8.
 硬度:
 杆部* ≥ 950 HV 0,3
 头部 45 ± 5 HRC
 核抗张强度: > 1400 N/mm²

237.8.

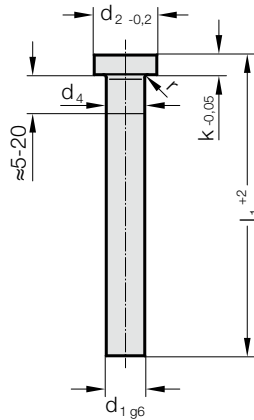

☞ 材料说明和其他材料见E章开头。

结构:

轴杆精密打磨, 经氮化处理。
 头部顶锻并回火。
 头部下方顶锻加粗
 取消, 依据制造商操作程序。

d_4 : 对于 $d_1 < 5$ mm, $d_4 = d_1 + 0.03$
 对于 $d_1 \geq 5$ mm, $d_4 = d_1 + 0.04$
 对于 $d_1 \geq 18$ mm, $d_4 = d_1 + 0.07$

237.8. 弹顶销, 表面渗氮, DIN 1530-1 A-Typ

d_1	d_2	k	r	l_1	100	125	160	200	250	315	400	500	630	800	1000
6	12	5	0.5		●	●	●	●	●	●	●	●	●	●	
6.2	12	5	0.5		●	●	●	●	●	●	●	●	●	●	
6.5	12	5	0.5		●	●	●	●	●	●	●	●	●	●	
6.7	12	5	0.5		●	●	●	●	●	●	●	●	●	●	
6.9	12	5	0.5		●	●	●	●	●	●	●	●	●	●	
7	12	5	0.5		●	●	●	●	●	●	●	●	●	●	
7.2	12	5	0.5		●	●	●	●	●	●	●	●	●	●	
7.8	12	5	0.5		●	●	●	●	●	●	●	●	●	●	
8	14	5	0.5		●	●	●	●	●	●	●	●	●	●	●
8.2	14	5	0.5		●	●	●	●	●	●	●	●	●	●	●
8.4	14	5	0.5		●	●	●	●	●	●	●	●	●	●	●
8.5	14	5	0.5		●	●	●	●	●	●	●	●	●	●	●
9	14	5	0.5		●	●	●	●	●	●	●	●	●	●	●
9.7	14	5	0.5		●	●	●	●	●	●	●	●	●	●	●
10	16	5	0.5		●	●	●	●	●	●	●	●	●	●	●
10.2	16	5	0.5		●	●	●	●	●	●	●	●	●	●	●
10.5	16	5	0.5		●	●	●	●	●	●	●	●	●	●	●
11	16	5	0.5		●	●	●	●	●	●	●	●	●	●	●
12	18	7	0.8		●	●	●	●	●	●	●	●	●	●	●
12.2	18	7	0.8		●	●	●	●	●	●	●	●	●	●	●
12.5	18	7	0.8		●	●	●	●	●	●	●	●	●	●	●
14	22	7	0.8		●	●	●	●	●	●	●	●	●	●	●
16	22	7	0.8		●	●	●	●	●	●	●	●	●	●	●
18	24	7	0.8		●	●	●	●	●	●	●	●	●	●	●
20	26	8	1		●	●	●	●	●	●	●	●	●	●	●
25	32	10	1		●	●	●	●	●	●	●	●	●	●	●
32	40	10	1		●	●	●	●	●	●	●	●	●	●	●

订购示例:

弹顶销, 表面渗氮, DIN 1530-1 A-Typ =237.8.
 轴径 d_1 6.2 mm = 0620.
 长度 l_1 100 mm = 100
 订购编号 =237.8. 0620. 100