

Angular Spherical Plain Bearing

Series GE...SWE

Angular spherical plain bearing, mating surface hard chrome/
FLUROGLIDE®, maintenance free

For use with high radial load in combination with axial load

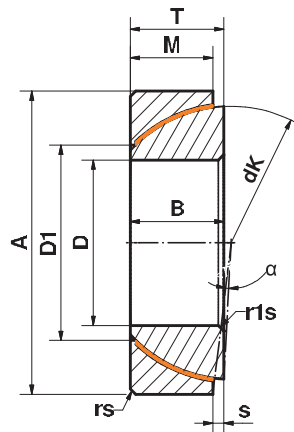

| Size (D) | D1 | B | M | A | T | S | r _s , r _{1s} min | d _k | Radial load rating kN | | Tilting angle α ≈ | Weight g |
|------------------------------------|-------|----|------|------------------------------------|--------------------------------------|------|--------------------------------------|----------------|-----------------------|-----------|-------------------|----------|
| | | | | | | | | | Static C ₀ | Dynamic C | | |
| 25 ⁰ _{-0,012} | 31,8 | 15 | 14,0 | 47 ⁰ _{-0,014} | 15 ^{+0,25} _{-0,40} | 0,6 | 1,0 | 42,0 | 235 | 141 | 2,5 | 148 |
| 28 ⁰ _{-0,012} | 35,8 | 15 | 15,0 | 52 ⁰ _{-0,016} | 16 ^{+0,25} _{-0,40} | 1,0 | 1,0 | 47,0 | 287 | 171 | 2,0 | 186 |
| 30 ⁰ _{-0,012} | 36,8 | 17 | 15,0 | 55 ⁰ _{-0,016} | 17 ^{+0,25} _{-0,40} | 1,3 | 1,0 | 49,5 | 298 | 179 | 4,5 | 208 |
| 35 ⁰ _{-0,012} | 42,7 | 18 | 16,0 | 62 ⁰ _{-0,016} | 18 ^{+0,25} _{-0,40} | 2,1 | 1,0 | 55,5 | 345 | 207 | 4,0 | 268 |
| 40 ⁰ _{-0,012} | 47,7 | 19 | 17,0 | 68 ⁰ _{-0,016} | 19 ^{+0,25} _{-0,40} | 2,8 | 1,0 | 62,0 | 424 | 254 | 3,5 | 327 |
| 45 ⁰ _{-0,012} | 53,7 | 20 | 18,0 | 75 ⁰ _{-0,016} | 20 ^{+0,25} _{-0,40} | 3,5 | 1,0 | 68,5 | 494 | 296 | 3,0 | 416 |
| 50 ⁰ _{-0,012} | 59,7 | 20 | 19,0 | 80 ⁰ _{-0,016} | 20 ^{+0,25} _{-0,40} | 4,3 | 1,0 | 74,0 | 567 | 340 | 1,5 | 455 |
| 55 ⁰ _{-0,015} | 62,7 | 23 | 20,0 | 90 ⁰ _{-0,018} | 23 ^{+0,25} _{-0,50} | 5,0 | 1,0 | 82,0 | 681 | 408 | 4,0 | 645 |
| 60 ⁰ _{-0,015} | 70,0 | 23 | 21,0 | 95 ⁰ _{-0,018} | 23 ^{+0,25} _{-0,50} | 5,7 | 1,1 | 88,5 | 784 | 470 | 2,5 | 714 |
| 65 ⁰ _{-0,015} | 76,6 | 23 | 22,0 | 100 ⁰ _{-0,018} | 23 ^{+0,25} _{-0,50} | 6,5 | 1,1 | 93,5 | 836 | 502 | 1,0 | 759 |
| 70 ⁰ _{-0,015} | 82,6 | 25 | 23,0 | 110 ⁰ _{-0,018} | 25 ^{+0,25} _{-0,50} | 7,2 | 1,1 | 102,0 | 972 | 583 | 2,0 | 1.040 |
| 80 ⁰ _{-0,015} | 91,6 | 29 | 25,5 | 125 ⁰ _{-0,020} | 29 ^{+0,25} _{-0,50} | 8,6 | 1,1 | 115,0 | 1.184 | 711 | 3,5 | 1.540 |
| 90 ⁰ _{-0,020} | 100,9 | 32 | 28,0 | 140 ⁰ _{-0,020} | 32 ^{+0,25} _{-0,60} | 10,1 | 1,5 | 128,5 | 1.490 | 894 | 3,5 | 2.090 |
| 100 ⁰ _{-0,020} | 114,6 | 32 | 31,0 | 150 ⁰ _{-0,020} | 32 ^{+0,25} _{-0,60} | 11,6 | 1,5 | 141,0 | 1.848 | 1.109 | 0,5 | 2.340 |
| 110 ⁰ _{-0,020} | 126,5 | 38 | 34,0 | 170 ⁰ _{-0,020} | 38 ^{+0,25} _{-0,60} | 13,0 | 2,0 | 155,0 | 1.967 | 1.180 | 3,0 | 3.680 |
| 120 ⁰ _{-0,020} | 136,5 | 38 | 37,0 | 180 ⁰ _{-0,025} | 38 ^{+0,25} _{-0,60} | 14,5 | 2,0 | 168,0 | 2.585 | 1.551 | 0,5 | 3.970 |
| 130 ⁰ _{-0,020} | 144,0 | 45 | 43,0 | 200 ⁰ _{-0,025} | 45 ^{+0,35} _{-0,70} | 18,0 | 2,5 | 188,0 | 3.412 | 2.047 | 1,0 | 5.920 |
| 140 ⁰ _{-0,020} | 161,5 | 45 | 43,0 | 210 ⁰ _{-0,025} | 45 ^{+0,35} _{-0,70} | 19,0 | 2,5 | 198,0 | 3.286 | 1.972 | 1,0 | 6.330 |
| 150 ⁰ _{-0,025} | 171,4 | 48 | 46,0 | 225 ⁰ _{-0,030} | 48 ^{+0,35} _{-0,70} | 20,0 | 3,0 | 211,0 | 3.814 | 2.288 | 1,0 | 8.010 |
| 160 ⁰ _{-0,025} | 182,4 | 51 | 49,0 | 240 ⁰ _{-0,030} | 51 ^{+0,35} _{-0,70} | 20,0 | 3,0 | 225,0 | 4.524 | 2.714 | 1,0 | 9.790 |
| 170 ⁰ _{-0,025} | 194,4 | 57 | 55,0 | 260 ⁰ _{-0,035} | 57 ^{+0,35} _{-0,70} | 21,0 | 3,0 | 246,0 | 5.872 | 3.523 | 1,0 | 12.300 |
| 180 ⁰ _{-0,025} | 206,4 | 64 | 61,0 | 280 ⁰ _{-0,035} | 64 ^{+0,35} _{-0,70} | 21,0 | 3,0 | 260,0 | 6.536 | 3.922 | 1,0 | 17.400 |
| 190 ⁰ _{-0,030} | 212,5 | 64 | 62,0 | 290 ⁰ _{-0,035} | 64 ^{+0,35} _{-0,80} | 26,0 | 3,0 | 275,0 | 7.352 | 4.410 | 0,5 | 18.200 |
| 200 ⁰ _{-0,030} | 229,4 | 70 | 66,0 | 310 ⁰ _{-0,035} | 70 ^{+0,35} _{-0,80} | 26,0 | 3,0 | 290,0 | 7.725 | 4.635 | 1,5 | 23.800 |

Materials:

Housing disk: Bearing steel 100Cr6, hardened and phosphated, with FLUROGLIDE® bonded to the inner surface

Inner disk: Bearing steel 100Cr6, hardened, ground, polished, hard chrome plated

On request available in stainless steel

Please note that the numbers pointed off on the pages 17 to 23 and 25 in the data sheets, signalise a thousands place. And the numbers with thousands separators (comma) signalise a decimal point.