

● ● ● Price index



IPA Qualification Certificate:  
Cleanroom test  
upon request



Special equipment:  
Electrically conductive ESD/ATEX  
version upon request



UL94-V2 classifications  
upon request



Easy to assemble and to disassemble



When to use the Series 06:

- High torsional rigidity
- If price is an issue
- If connection options are required  
(Quicksnap, Quickfix, ...)



When not to use it:

- If snap-open links are required
  - ▶ Series 07 Zipper, page 4.10
  - ▶ Series B07 E2 micro, page 5.30
- If quick insertion of cables with  
preassembled connectors is required
  - ▶ Series E06 Easy Chain®, page 3.20
- If very quiet operation is required
  - ▶ Series 045 E2 micro, page 5.18

- 1 High torsional rigidity
  - 2 Very light weight - low price
  - 3 Dirt-repellent exterior
  - 4 Mounting bracket with integrated strain relief
  - 5 Easy to fill configuration
- ▶ Series E06 Easy Chain®, page 3.20
- 6 Snap-open configuration
- ▶ Series 07 Zipper, page 4.10
- ▶ Series B07 E2 micro, page 5.30
- 7 Molded-in separator available  
Series 06.16.018.S1



Order example complete E-Chain®

Please indicate chain-lengths or number of links Example: 1 m or 50 links

1 m 06.20.038.0



E-Chain®

1 set 060.20.12PZ



Mounting bracket



### Unsupported length

$FL_G$  = with straight upper run

$FL_B$  = with permitted sag

Further information ► Design, page 1.12

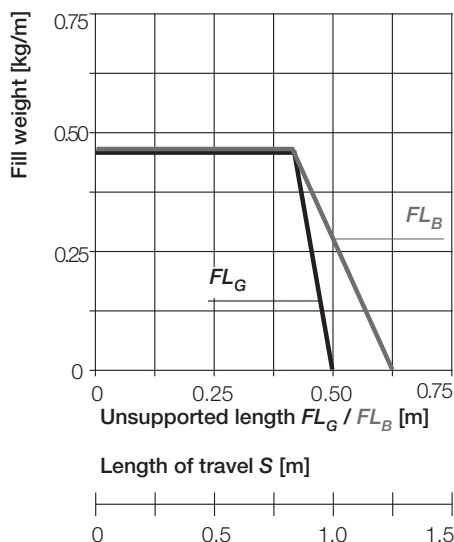
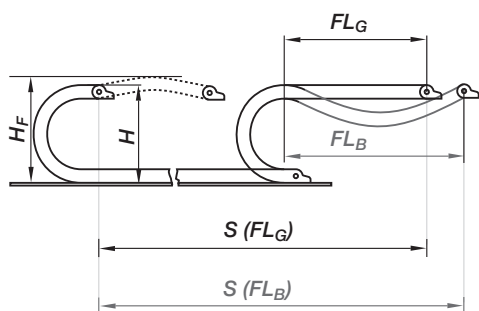

- $S$  = Length of travel
- $R$  = Bending radius
- $H$  = Nominal clearance height
- $H_F$  = Required clearance height
- $D$  = Overlength E-Chain® radius in final position
- $K = \pi \cdot R + \text{"safety"}$

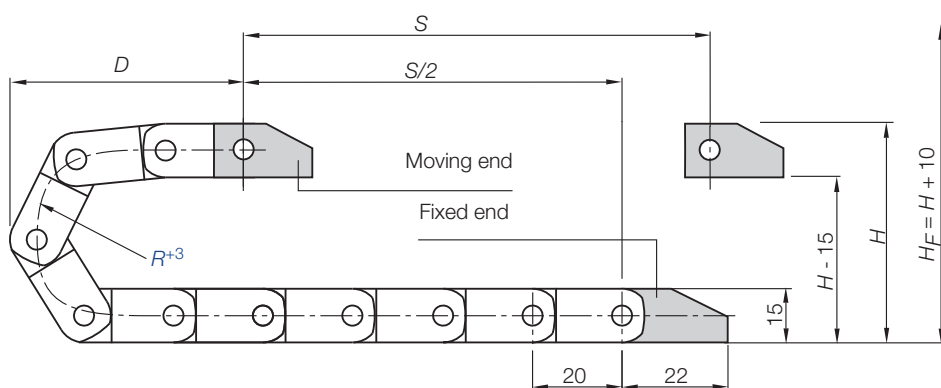

### Short travels - unsupported

Unsupported E-Chains® feature positive camber over short travels. This must be accounted for when specifying the clearance height  $H_F$ . Please consult igus® if space is particularly restricted.

Pitch = 20 mm/link    Links/m = 50 (1.000 mm)    Chain length =  $S/2 + K$

R	018	028	038
H	52	72	92
D	45	55	65
K	100	140	160

The required clearance height:  
 $H_F = H + 10$  mm  
 (with 0,2 kg/m fill weight)

10,5

E2 micro  
 Inner height: 10,5 mm

Phone +49- (0) 22 03-96 49-800  
 Fax +49- (0) 22 03-96 49-222

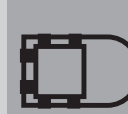

► page 5.9

Speed / acceleration $FL_G$	max. 20 [m/s] / max. 200 [m/s <sup>2</sup> ]
Speed / acceleration $FL_B$	max. 3 [m/s] / max. 6 [m/s <sup>2</sup> ]
Gliding speed / acceleration (maximum)	max. 3 [m/s] / max. 10 [m/s <sup>2</sup> ]
Material - permitted temperature °C	igumid G / -40° up to +120° C
Flammability class, igumid G	VDE 0304 IIC UL94 HB

### Technical Data



Details of material properties  
 ► page 1.38

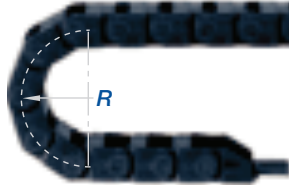
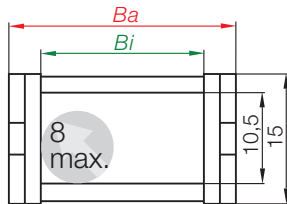

## Series 06 E-Chain® - non snap-open

Part No.	$B_i$ [mm]	$B_a$ [mm]	$R$ [mm]	Bending radii	Weight [kg/m]
06.06.□.0	6	12,5	018	028 038	≈ 0,13
06.10.□.0	10	16,5	018	028 038	≈ 0,14
06.16.□.0	16	22,5	018	028 038	≈ 0,16
06.20.□.0	20	27,0	018	028 038	≈ 0,17
06.30.□.0	30	37,0	018	028 038	≈ 0,20
06.40.□.0	40	47,0	018	028 038	≈ 0,23
06.50.□.0	50	57,0	018	028 038	≈ 0,26
06.64.□.0	64	71,0	018	028 038	≈ 0,30

Supplement Part No. with required radius. Example: 06.20.□.038.0

0 = standard color, other colors ► page 1.39 · Pitch = 20 mm/link - Links/m = 50

## Part No. structure

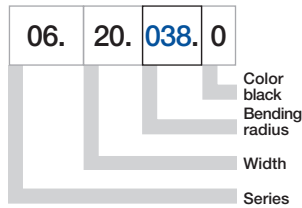

Phone +49- (0) 22 03-96 49-800  
Fax +49- (0) 22 03-96 49-222

igus® GmbH  
51147 Cologne

Internet: [www.igus.eu](http://www.igus.eu)  
E-mail: [info@igus.de](mailto:info@igus.de)



**Polymer, one-piece**

- One-piece mounting bracket
- Corrosion-resistant
- Available preassembled
- Inner and outer attachment possible
- Available with or without strain relief tiwrap plates

Moving end with bore  
(outer link) 060...1(PZ)

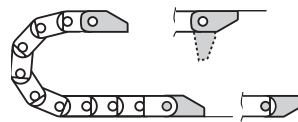

060...2(PZ) Fixed end  
with pin (inner link)

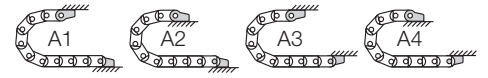

Possible installation conditions for assembled mounting brackets ▶ Order example "preassembled" below

060...1(PZ)  
Moving end

060...2(PZ)  
Fixed end

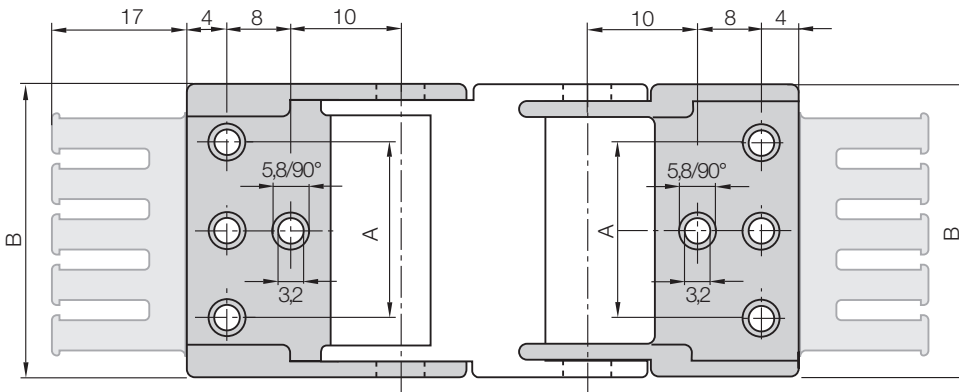

060.06.12 - 060.20.12: center bores only  
060.30.12 - 060.64.12: outer bores only

For E-Chain®	Part No. full set with tiwrap plate	Part No. full set without tiwrap plate	Number of teeth	Dim. A [mm]	Dim. B [mm]
06.06. ▶	060.06. 12 PZ	060.06. 12	1	-	12,5
06.10. ▶	060.10. 12 PZ	060.10. 12	1	-	16,5
06.16. ▶	060.16. 12 PZ	060.16. 12	2	-	22,5
06.20. ▶	060.20. 12 PZ	060.20. 12	2	-	27,0
06.30. ▶	060.30. 12 PZ	060.30. 12	3	22	37,0
06.40. ▶	060.40. 12 PZ	060.40. 12	4	32	47,0
06.50. ▶	060.50. 12 PZ	060.50. 12	5	42	57,0
06.64. ▶	060.64. 12 PZ	060.64. 12	6	56	71,0

For the preassembled mode please add the index [A1]...[A4] e.g. 060.20. 12 PZ [A1]

**Dimensions and order configurations**

Strain relief is possible on the moving end and/or the fixed end.

**Part No. structure**

060.20. 12 PZ A1

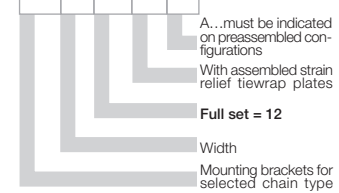

**Full set, for both ends:**

060.20. 12 PZ +tiwrap plate

**Single-part order:**

060.20. 1 PZ +tiwrap plate

Mounting bracket with bore

060.20. 2 PZ +tiwrap plate

Mounting bracket with pin

Phone +49- (0) 22 03-96 49-800  
Fax +49- (0) 22 03-96 49-222



**Quicksnap** - the complete, detachable mounting unit, upon request

Part No. 060.10.QS, Art. Nr. 060.16.QS,

Part No. 060.20.QS, Art. Nr. 060.40.QS



**Quickfix** - mounting bracket with dowel, upon request

**Additional Features**