

3.1.3.6 lifgo® linear gear rack protection SB & end plate • Dimension sheet

This gear rack protection is suitable for use in welding areas (SB). The end plate is used for mounting the gear rack protection on the lifgo® linear gear rack.

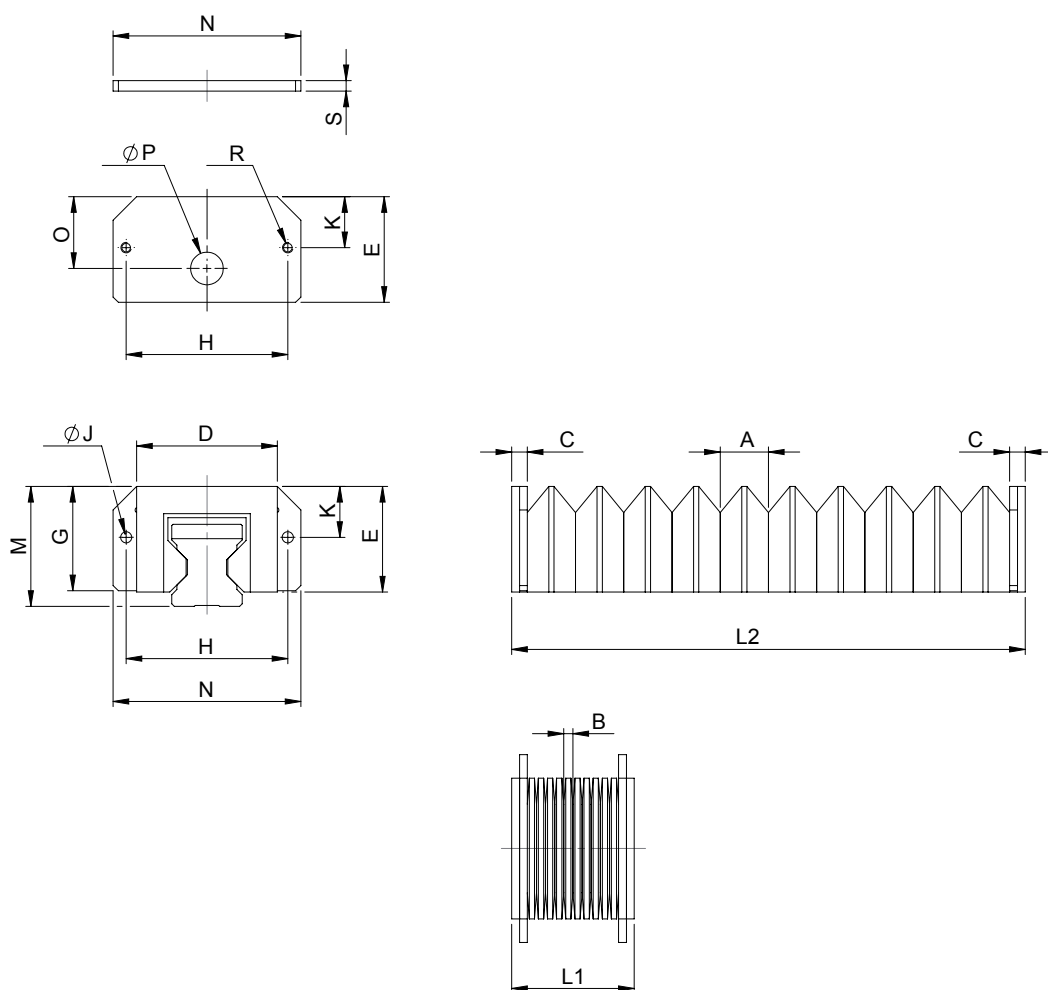

! Check whether the operating conditions require a gear rack protection.
 This gear rack protection is **suitable for use in welding areas**.
 It is shipped with retaining plates and screws.

Note that in its retracted state, the "SB" version requires 1,0 mm more installation space per fold (dimensions A, B and C).

The gear rack protection is silicone-free.

Always add the number of folds "F = _ _ _" to the article number.

lifgo® linear gear rack protection SB		Unit	5.0	5.1	5.3
Stroke per fold	A	mm	18,5	18,5	28,5
	B	mm	3,5	3,5	3,5
	(A - B)	mm	15	15	25
	C	mm	6	6	6
Number of folds	D	mm	50	54	92
	E	mm	36,5	40,5	66,5
	F	each	as per customer data		
	G	mm	36	40	66
Stroke	H	mm	58	62	100
	J	mm	∅ 4,3 √ 8,5 x 90°	∅ 4,3 √ 8,5 x 90°	∅ 4,3 √ 8,5 x 90°
	K	mm	18,5	19,5	23,5
	L	mm	$L = L2 - L1 = F \times (A - B)$		
	L1	mm	$L1 = 2 \times C + F \times B$		
	L2	mm	$L2 = 2 \times C + F \times A$		
	M	mm	40	46	71,5
	N	mm	68	72	112
	O	mm	24	27,5	45
	P	mm	∅ 10,5	∅ 12,5	∅ 20,5
R	mm	M4	M4	M4	
S	mm	4	4	4	

Article number	5.0	5.1	5.3
lifgo® linear gear rack protection SB	500 516	500 517	500 518
lifgo® linear end plate	500 540	500 542	500 544