

门部件 搭扣

选型指南

举例	型号
Code	No.
标准	DK11S 1

■ 搭扣1

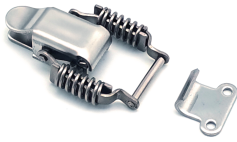

材质	表面处理
SUS304	滚磨

DK11SA

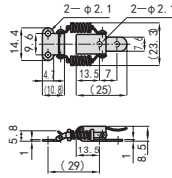

推荐安装孔间距

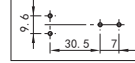

DK11S1

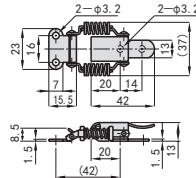

推荐安装孔间距

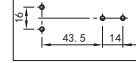

DK11S2

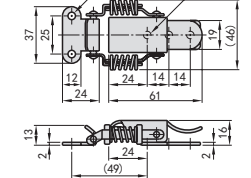

推荐安装孔间距



DK11SLA

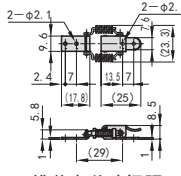

推荐安装孔间距

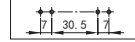

DK11SL1

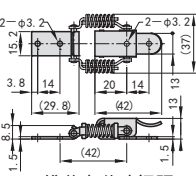

推荐安装孔间距

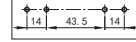

DK11SL2

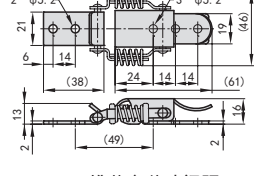

推荐安装孔间距

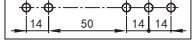

注：()内尺寸是指紧固量为0mm时的尺寸。(自由度)请根据紧固力任意调节安装尺寸。

型号		拉伸负荷 N (kgf)	DK11S 质量 (g)	DK11SL 质量 (g)
Code	No			
DK11S	A	20 (2)	9.8	10
	1	68 (7)	35.8	40
DK11SL	2	170 (17.4)	77.8	90

■ 搭扣2



材质	表面处理
SUS304	滚磨

DK12S1 (不锈钢)

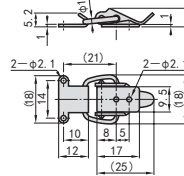

推荐安装孔间距



DK12S2 (不锈钢)

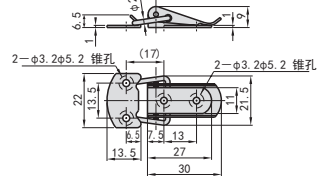

推荐安装孔间距

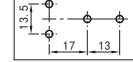

推荐安装螺丝
十字孔圆头
小螺丝M2

DK12S3 (不锈钢)

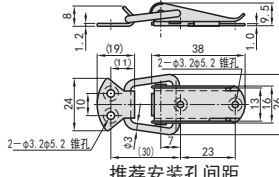

推荐安装孔间距

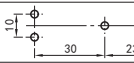

DK12S4 (不锈钢)

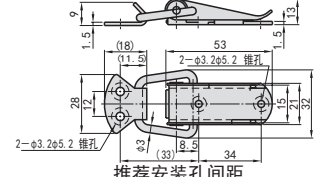

推荐安装孔间距

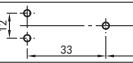

型号		拉伸负荷 N (kgf)	重量 (g)
Code	No.		
DK12S	1	49 (5)	10.8
	2	78 (8)	11.7
	3	98 (10)	17.8
	4	147 (15)	36.9

支柱

支柱座

支柱
固定夹

触摸屏
支架

支脚

脚轮

拉手

手柄·
旋钮

手轮

铰链

门部件