

# Keyboards, supports and drawers

## Drawer for keyboard and mouse

### with mousepad support

For installation in:

- Any sufficiently large surface (e.g. door, side panel)
- Front panels

Suitable for accommodating

- Keyboards up to a maximum of 460 x 42 x 170 mm
- Standard mouse and mousepad

### Design:

- Drawer and housing: With side pull-out mousepad support and tray
- Front panel: With 3 mm double-bit lock insert, folds out as handrest

Width mm	U	Depth mm	Model No.
482.6 (19')	3.5	261	6003.000

### Material:

- Drawer and enclosure: Sheet steel
- Front panel: Aluminium

### Surface finish:

- Drawer and enclosure: Textured paint
- Front panel: Natural anodised

### Supply includes:

- Assembly parts



### Accessories:

- Standard double-bit lock insert may be exchanged for 27 mm lock inserts, type A, see page 570

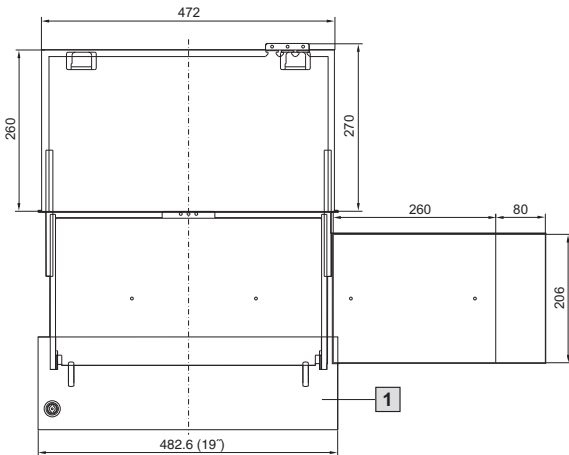

Mounting cut-out for installation in surfaces

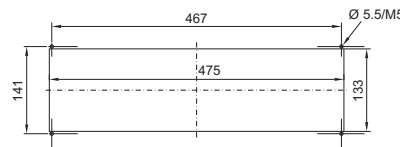

1 Front trim panel

## Keyboard drawer, 1 U

### for 482.6 mm (19') mounting level

This space-saving keyboard drawer is screw-fastened to the front and rear 482.6 mm (19') mounting angles. The installation spacing is infinitely adjustable from 460 – 800 mm. It is fully extendible, lockable, with strain relief and hinged cable support.

The drawer is suitable for accommodating 482.6 mm (19') keyboards.

### Interior dimensions:

- W x H x D approx. 420 x 40 x 220 mm

### Material:

- Sheet steel

### Colour:

- RAL 7035

### Supply includes:

- Assembly parts, excluding keyboard

### Note:

- Monitor/keyboard unit, 1 U, see page 461

Distance between levels mm	Model No.
460 – 800	7281.200

