

Signal pillars



Signal pillars, modular

Benefits:

- Simple assembly and contact via bayonet fastener.
- Configuration of up to five components with the same voltage.
- The incandescent lamps are replaced in seconds – no need for tools.
- Components are available in a range of colours and voltages.

For modular configuration from:

- Connection components
- Optical components
- Incandescent lamps/LED lamps
- Acoustic components
- Label panel



Connection component

for signal pillars, modular

Optionally for conduit or wall/base mounting. Screw terminals in the connection component. With cover for optical components. Contact hazard protection to VDE.

Material:

Enclosure of polyamide

Colour:

Black

Protection category:

IP 54

Connection component	Model No. SG
For conduit mounting	2368.000
For wall/base mounting	2368.010



Accessories:

Mounting components for wall/base mounting, see page 1128.

Mounting components for conduit mounting, see page 1129.

Mounting components for support arm systems, see page 1129.

Connection component for conduit mounting
SG 2368.000

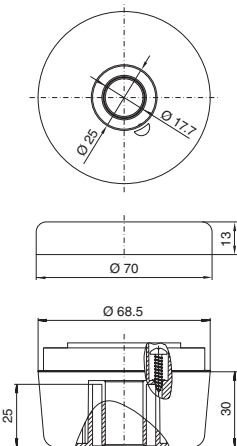

Connection component for wall/base mounting
SG 2368.010

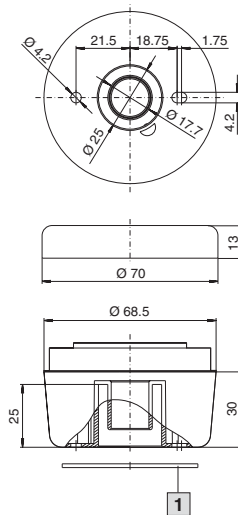

1 Seal

Connection diagram

