

# AL603F/SF

**Energy efficiency, brightness and elegance**

The innovative SCHNEIDER aluminium folding door AL603F/SF consists of specifically developed thermally separated profiles, which result in a substantially better thermal insulation than with normal profiles. The AL603F/SF profiles are connected using a screw-/plug-type system, forming a door with high torsional stiffness. As with the AL602F/SF, solid running rails, hinges and corner connections enhance the high load capacity and thus also enable large glass panels.

## HIGHLIGHTS

- › Thermally separated aluminium profile
- › Triple glazing with a U-value of 0.6 W/m<sup>2</sup>K
- › Continuous triple glazing up to 3 m<sup>2</sup>, max. height 3,200 mm
- › Area of application up to 15.6 m in width x 5.6 m in height
- › Reinforced adhesive joints at the frame corners

Technical data	AL603F/SF
Design depth	60 mm
Frame width	min. 87 mm
max. door size (OW x OH)	15,600 x 5,600 mm
max. leaf width	1,300 mm
Partition variants	2+0 / 2+1 / 2+2 / 3+0 / 3+1 / 3+2 / 3+3 / 4+0 / 4+1 / 4+2 / 4+3 / 4+4 / 5+0 / 5+1 / 5+2 / 6+0 / 6+1 / 6+2 / 6+4 / 6+6
Door with active leaf (OW x OH)	max. 5,500 x 3,000 mm
Built-in access door	max. height 2,500 mm
Insulating safety glass	max. 2 m <sup>2</sup> continuous per field
Size of fully glazed doors	max. 4,200 mm
Automatic opening	possible with partition 2+2
Resistance against wind load	min. Class 2-5
Watertightness	Class 0-3
Airtightness	Class 0-3
Thermal resistance	on request
Fire protection	Class 0
Motion cycles	150,000



## DOOR DESIGN AL603F/SF

Stable aluminium frame design with highly rigid connections, extremely strong corner connections and thermal separation



### Profile

- › Thermally separated
- › Design depth: 60 mm
- › Frame width: min. 87 mm
- › Wall thickness of the profiles: min. 2-4 mm
- › Frame anodised with A6/C0 or high-quality powder coating possible

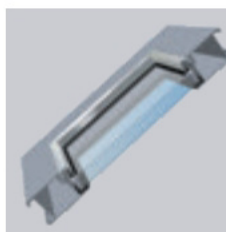

### Fillings

- › Double-walled panels
  - + Aluminium panels: 42 mm
  - + Steel ISO panel: 40 mm
- › Double-walled and/or triple glazing or multi-skin sheets in different variants and thicknesses



### Colour

- › Anodised with A6/C0
- › Powder coating in façade quality or highly weather-resistant
  - + RAL at customer's choice
  - + Metallic
  - + Wood décor



### Operation

- › Manual
- › Fast automatic opening
- › E-drive Basic or Power-F

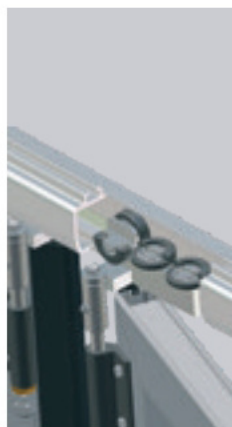

### Running rail

- › Of 5 mm thick aluminium profile anodised with A6/C0 or coated
- › Steel rail with 180° opening
- › Suspension of the door leaves on roller units with horizontal and vertical guide rollers
- › Integrated seal carrier with continuous lip sealing
- › Dust-proof, maintenance-free ball bearings
- › Opening angle: 90° or 180° (max. 3 leaves)
- › Rail remains clean, as it is only open towards the bottom
- › Ease of operation and smooth running



### Hinges

- › Hinge bolt stainless steel 20 mm
- › Hidden screwed aluminum hinges anodised with C35
- › Dust-proof thrust bearing between the hinge straps
- › Solid, adjustable, re-forgeable
- › Ease of operation, easy to replace, easily re-adjustable, no wear



### Finger-pinch protection

Safety with finger-pinch protection made of elastic non-decomposable EPDM rubber in all vertical closing edges, black

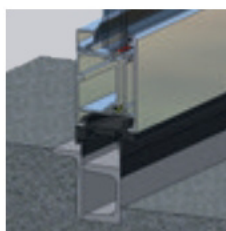

### Floor connection

- › Galvanised as standard
- › Threshold: L50, U50D, double bracket (Fig.)
- › Recessed floor guide: BF, BF heated, BF-light NIRO, BF-light NIRO heated



### Integrated door

- › Fast access to the hall without having to open the entire folding door.
- › Active leaf: entire door leaf with access function
- › Built-in access door: opening towards the outside with max. height 2,500 mm,
- › Threshold profile: max. 40 mm, low threshold possible