

Führungssäulen

Guide pillars

Colonnes de guidage

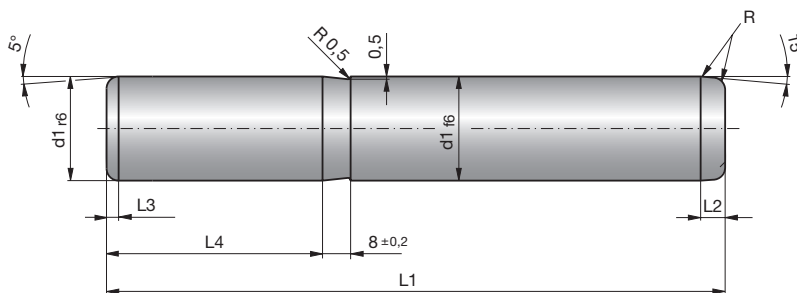

Z4318-

Mat.: ST
61+4HRC
~DIN 9833/ISO 9182-3



Z4318-d1-L1



Einsatzstahl gehärtet 61+4HRC,
Eht = 2,1 mm

Case hardening 61+4HRC,
Eht = 2,1 mm

Acier cémenté trempé 61+4HRC,
Eht = 2,1 mm

Zentrierbohrung
Centre holes
Trous de centre
~DIN 332-DS

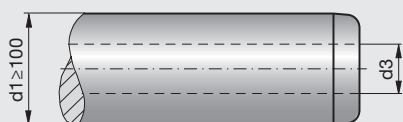
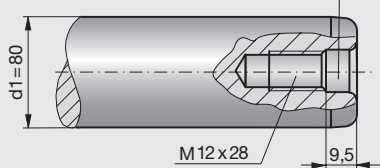

Bei $d1 \geq 63$ mm - Säule bitte einschrumpfen
If $d1 \geq 63$ mm - Please contract pillar
Pour $d1 \geq 63$ mm - Monter la colonne avec refroidissement

d1	L1	d3	M	L2	L3	L4	d1	L1	d3	M	L2	L3	L4
25	125	0	0	8	4	40	63	250	0	0	10	4	80
	140	0	0	8	4	40		280	0	0	10	4	80
	160	0	0	8	4	40		315	0	0	10	4	80
	180	0	0	8	4	40		355	0	0	10	4	80
	200	0	0	8	4	40		400	0	0	10	4	80
	224	0	0	8	4	40		80	200	0	12x28	10	4
32	140	0	0	8	4	45	224		0	12x28	10	4	100
	160	0	0	8	4	45	250		0	12x28	10	4	100
	180	0	0	8	4	45	280		0	12x28	10	4	100
	200	0	0	8	4	45	315		0	12x28	10	4	100
	224	0	0	8	4	45	355		0	12x28	10	4	100
	250	0	0	8	4	45	400	0	12x28	10	4	100	
40	140	0	0	8	4	56	100	224	50	0	10	4	125
	160	0	0	8	4	56		250	50	0	10	4	125
	180	0	0	8	4	56		280	50	0	10	4	125
	200	0	0	8	4	56		315	50	0	10	4	125
	224	0	0	8	4	56		355	50	0	10	4	125
	250	0	0	8	4	56		400	50	0	10	4	125
50	280	0	0	8	4	56	125	450	50	0	10	4	125
	160	0	0	10	4	70		315	65	0	12	5	140
	180	0	0	10	4	70		355	65	0	12	5	140
	200	0	0	10	4	70		400	65	0	12	5	140
	224	0	0	10	4	70		450	65	0	12	5	140
	250	0	0	10	4	70		500	65	0	12	5	140
63	280	0	0	10	4	70	160	400	95	0	12	5	180
	315	0	0	10	4	70		450	95	0	12	5	180
	355	0	0	10	4	70		500	95	0	12	5	180
	400	0	0	10	4	80		560	95	0	12	5	180
	200	0	0	10	4	80							
	224	0	0	10	4	80							