

## SERIES 64

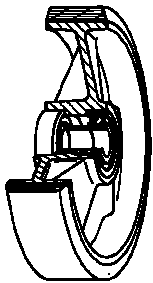

**“TR” POLYURETHANE WHEELS,  
CAST IRON CENTRE,  
FIXED BRACKET TYPE EE EHD**

### *Wheel description*



**Tread:** “TR” polyurethane, hardness 95 +/- 3 Shore A.

**Centre:** cast iron.

**Hub:** the housing is obtained by moulding and turning and contains ball bearings series Z

### *Bracket description*

**EE Extra Heavy Duty bracket (max. load capacity 3500 daN)**

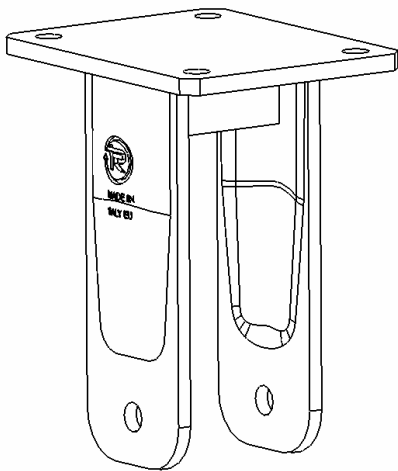

The bracket is made by a steel forged fixing plate with 4 holes, by two steel drawn sides and by a steel central stiffening. These elements are bounded by welding and properly protected against oxydation.