

PE Tee

PE T-stuk
PE T-Stück
Te PE
PE ti
Te en PE

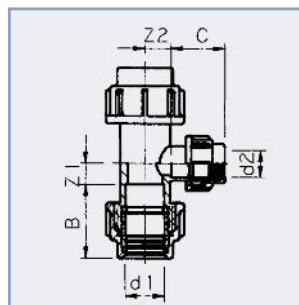

Art.code	d1	d2	Z1	Z2	B	C	PN	Quantity
7.16.020*	20	16	10	24	47	42	16	50
7.16.024*	25	16	15	16	51	42	16	50
7.16.025*	25	20	15	26	51	47	16	50
7.16.032*	32	25	19	31	57	51	16	50
7.16.040*	40	32	23	36	61	57	16	25
7.16.050	50	40	38	40	95	74	10	8
7.16.063	63	50	40	36	105	98	10	5
7.16.075	75	63	38	39	124	110	10	4

* = kiwa norm PN 16

PE elbow

PE knie
PE Winkel
Coude PE
PE curva
Codo en PE

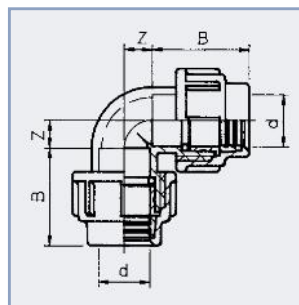

Art.code	d	Z	B	PN	Quantity
7.20.016*	16	10	42	16	100
7.20.020*	20	12	47	16	100
7.20.025*	25	14	51	16	100
7.20.032*	32	18	57	16	50
7.20.040*	40	21	61	16	50
7.20.050	50	40	90	16	12
7.20.063	63	50	105	16	8
7.20.075	75	38	124	10	6

* = kiwa norm PN 16