

Light bars one row

ALUFIX ECO Light bars are suitable for medium to large fixtures as basic frame material and also for connections direct to the workpiece.

They can be connected using the bores on all 4 sides with quick

or screw connectors, ECO couplings (page 196/197) are used for the face ends.

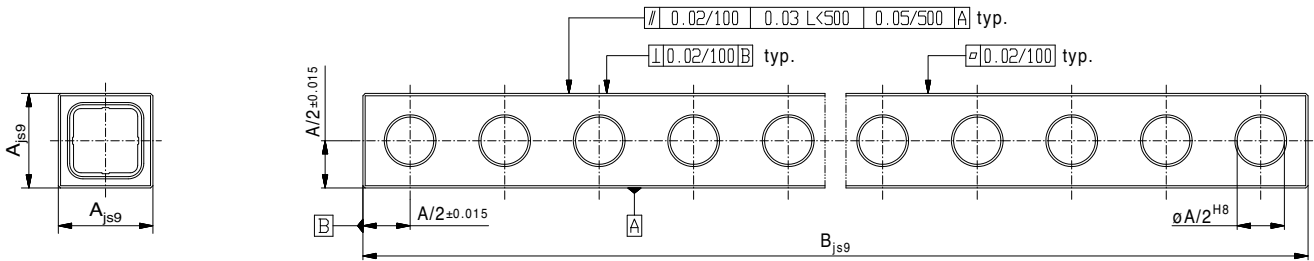

AF25 ECO

A=25, 25 x 25

Nr.	B	g
24340-E	50	40
25013-E	100	70
25374-E	150	110
24336-E	200	140
22946-E	250	170
24337-E	300	200
25012-E	350	240
23283-E	400	270
25890-E	450	300
22947-E	500	360
21333-E	600	430
24339-E	700	500
24189-E	800	570
25895-E	900	640
22948-E	1000	710

AF40 ECO

A=40, 40 x 40

Nr.	B	g
25039-E	120	150
25377-E	160	180
26505-E	200	200
25378-E	240	270
27342-E	280	300
25379-E	320	360
27183-E	360	400
23549-E	400	450
25945-E	480	540
27444-E	600	650
23550-E	800	900
24495-E	1000	1.100
23551-E	1200	1.350

AF50 ECO

A=50, 50 x 50

Nr.	L	g
28149-E	50	160
28150-E	100	320
28151-E	150	490
28152-E	200	640
28153-E	250	800
28154-E	300	960
28155-E	400	1.280
26933-E	500	1.600
28615-E	600	1.900
33297-E	800	2.600
26935-E	1000	3.200
33298-E	1200	3.800
26937-E	1500	4.900
26939-E	2000	6.400
26943-E	3000	9.800
26947-E	4000	13.000

