

Light bars rectangular

ALUFIX ECO Light bars are suitable for medium to large fixtures as basic frame material and also for connections direct to the workpiece.

They can be connected using the bores on all 4 sides with quick

or screw connectors, ECO couplings (page 196/197) are used for the face ends.

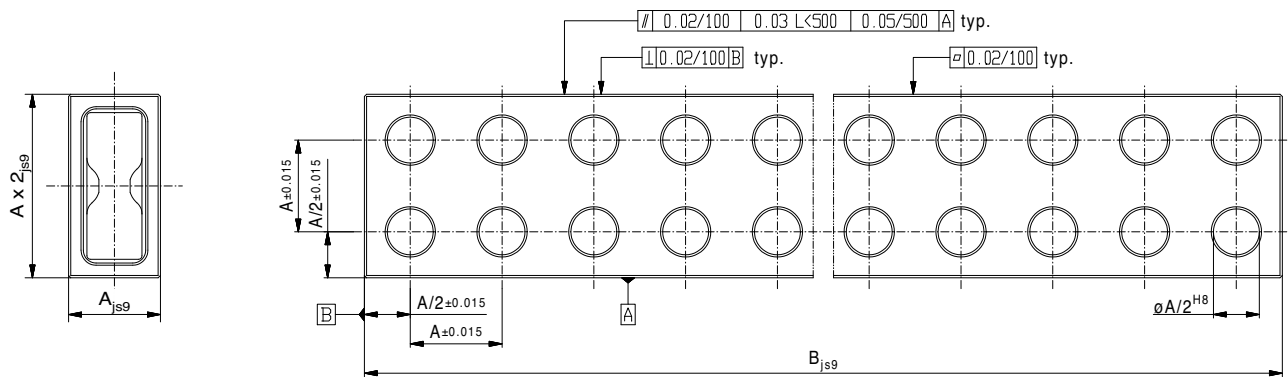

AF25 ECO

A=25, 25 x 50

Nr.	B	g
55090-E	50	80
55091-E	100	150
55092-E	150	230
55093-E	200	300
55094-E	250	380
55095-E	300	450
55097-E	400	600
55099-E	500	750
55101-E	600	900
55103-E	700	1.050
55105-E	800	1.200
55107-E	900	1.350
55109-E	1000	1.500
55113-E	1200	1.800
55119-E	1500	2.250
55129-E	2000	3.000

AF40 ECO

A=40, 40 x 80

Nr.	B	g
57400-E	80	279
57401-E	120	418
57402-E	160	557
57403-E	200	697
57404-E	240	836
57405-E	280	975
57406-E	320	1.115
57408-E	400	1.393
57410-E	480	1.672
57413-E	600	2.090
57418-E	800	2.786
57423-E	1000	3.483
57428-E	1200	4.180
57438-E	1600	5.573
57448-E	2000	6.966
57473-E	3000	10.449



i ALUFIX ECO elements can be anodized in different colours. The colour natural (-E) is standard, blue (-E2) is available as an alternative. Black (-E1) and other colours on request

i Other dimensions on request

